

DETAIL-A

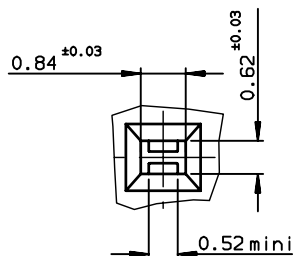

SECTION-FF

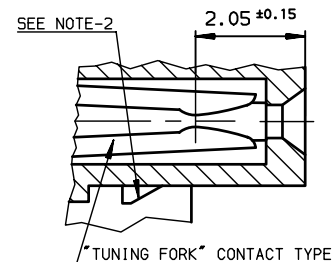

DETAIL OF PRESS-IN PEGS

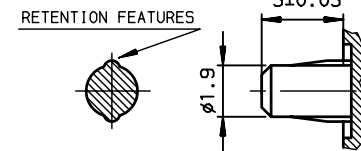

SEE NOTE-1

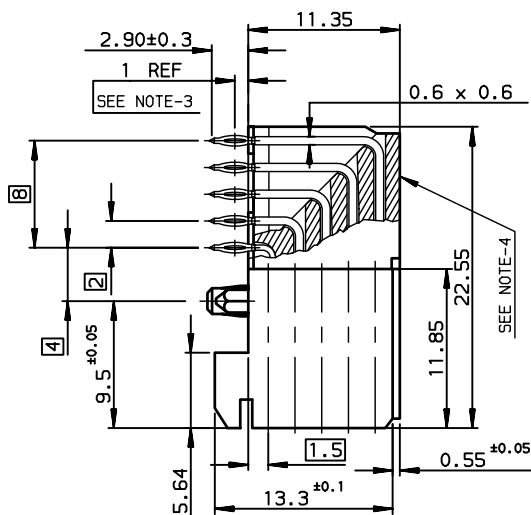

LAYOUT FOR P.C.B

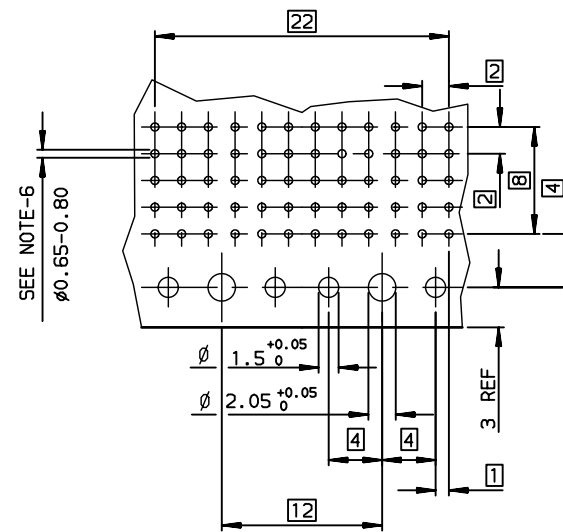

(REDUCED SCALE SHEET)

TIN LEAD PART NUMBER

Part Number: HM1F52FDP400H6P

LEAD FREE PART NUMBER

Part Number: HM1F52FDP400H6PLF

NOTE-1: PRESS-IN RETENTION PEG

NOTE-2: PLUG FOR CODING KEY FIXING

NOTE-3: EYE OF THE NEEDLE PRESS-FIT CTS TYPE

NOTE-4: FLAT ROCK INSERTION TOOLING IN PCB, SEE DRW REF:C-8626-1003

NOTE-5: METALIZED HOLE DEFINITION,SEE DRW REF:C01-8626-000P

SPECIFIC DATAS:

VISUAL INSPECTION: 100%

- marking failure
- housing material failure
- spoilt housing
- stained housing
- broken contacts (twisted or Loosen)

rev	ecn no	dr	date
A	-	-	-
B	L505-004	MLE	2005/02/11
C	L506-0092	MLE	2006/06/01
-	-	-	-
-	-	-	-
-	-	-	-

GENERAL CHARACTERISTICS AND ROHS INFORMATIONS:  
SEE DRAWING C-8626-000P

European Views

www.fciconnect.com		surface ISO 1302 ✓	tolerance std ISO 406 ISO 1101	projection mm	size A3	Scale 2.5
TOLERANCES UNLESS OTHERWISE SPECIFIED						
Dr	PERRICHOT	2001/06/26	ANGULAR	0.X	±0.1	ECN L506-0092
Eng	LENOIR	2001/06/26	LINEAR	0.XX	±0.1	
Chr	LEGARE	2001/06/26	0.XX' ±2'	0.XXX	±0.1	
Appr	LEGARE	2001/06/26	Product family		METRAL	Spec ref -
FCI		METRAL FEMALE 5 ROWS			60 CTS REIGHT ANGLE PF	
catalog no		-			C-8626-11139	
-		-			CUSTOMER sheet 1 of 1	

