



IES-1050

# IES-1050

## ➤ Industrial 5-port Unmanaged Ethernet Switch

### Features

- Supports 5 ports 10/100Base-T(X)
- Rigid IP-30 housing design
- DIN-Rail and panel mounting enabled



### Introduction

IES-1050 is unmanaged Ethernet switch with 5x10/100Base-T(X) ports. With very compact size of housing, you can install IES-1050 easily. In addition, IES-1050 is with rigid IP-30 housing design and can operate under harsh environment. and can satisfy most requirement of operation.

### Practical Operation

IES-1050 can be used in connecting several Ethernet devices like Ethernet I/O, IP-Camera or other Ethernet switches. In addition, its compact size enables easily installation and minimize space requirement.

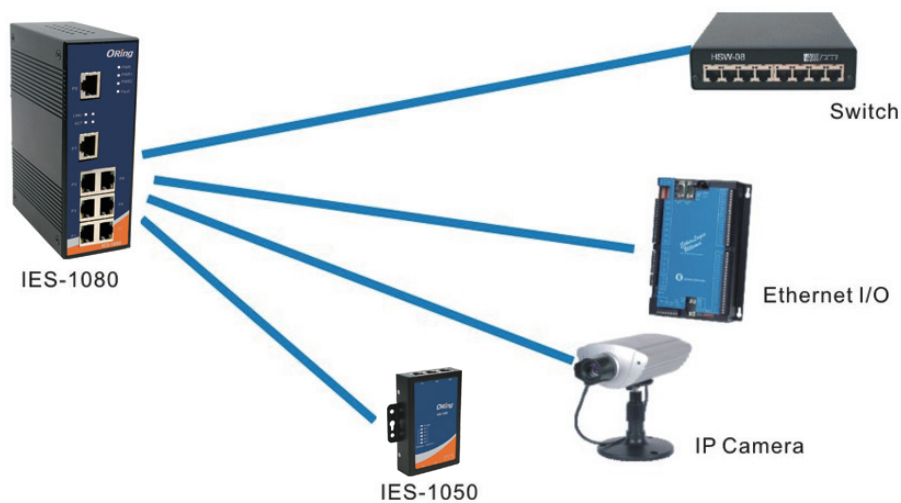

Connections of Ethernet devices

## Dimensions

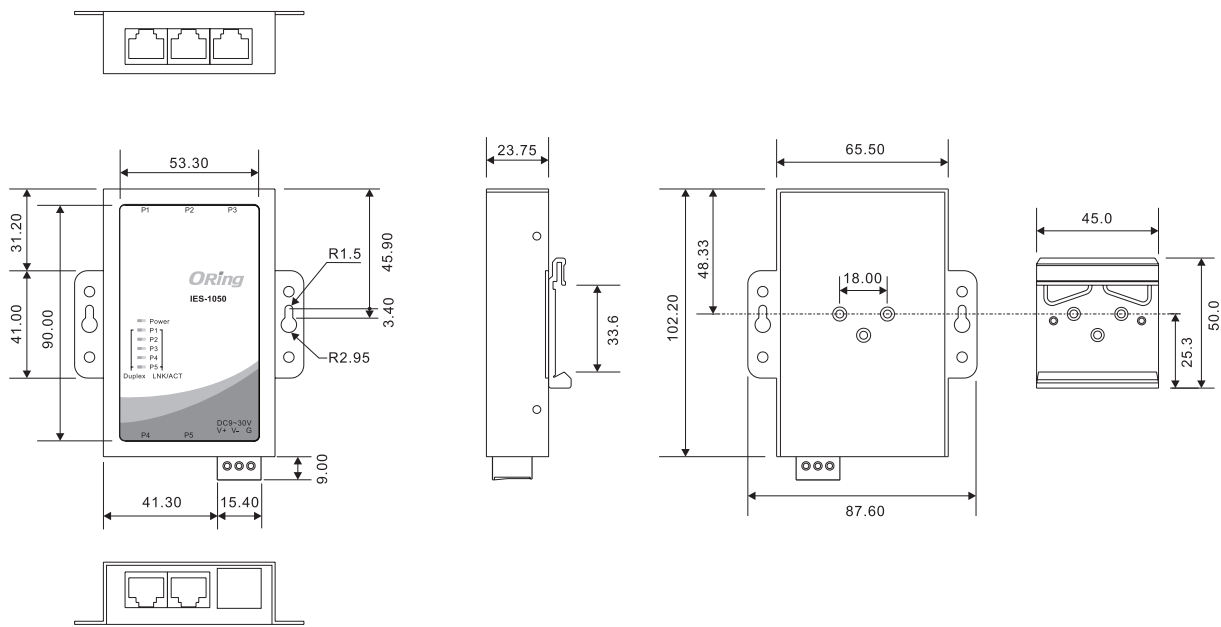

(Unit=mm)

## Specifications

ORing Switch Model	IES-1050
<b>Physical Ports</b>	
10/100Base-T(X) Ports in RJ45 Auto MDI/MDIX	5
<b>Technology</b>	
Ethernet Standards	IEEE 802.3 for 10Base-T, IEEE 802.3u for 100Base-T(X) and 100Base-FX, IEEE 802.3x for Flow control
Processing	Store-and-Forward
<b>LED Indicators</b>	
Power / Ready Indicator	Green : Power LED x 1
10/100Base-T(X) RJ45 port Indicator	Green for port Link/Act. Amber for duplex indicator
<b>Power</b>	
Input Power	9 ~ 30 VDC voltage power input
Power Consumption (Typ.)	3W
Overload Current Protection	Present
Reverse Polarity Protection	Present
<b>Physical Characteristic</b>	
Enclosure	IP-30
Dimension (W x D x H)	87.6(W) x 23.75(D) x 102.2(H) mm (3.45x0.94x4.02 inch.)
Weight (g)	305 g