

Termination N-Type

50Ω

DC to 8000 MHz

KARN-50+



Generic photo used for illustration purposes only

CASE STYLE: LL718

| Connectors | Model |
|-------------|----------|
| N-Type-Male | KARN-50+ |

+RoHS Compliant

The +Suffix identifies RoHS Compliance. See our web site for RoHS Compliance methodologies and qualifications

Maximum Ratings

Operating Temperature -55°C to 100°C

Storage Temperature -55°C to 100°C

Permanent damage may occur if any of these limits are exceeded.

Features

- wideband coverage, DC to 8000 MHz
- useable to 9000 MHz (return loss, 20 dB typ. at 9000 MHz)
- rugged construction
- brass body with trimetal finish

Applications

- cellular communications
- satellite communications
- defense communications
- test set-up

Outline Drawing

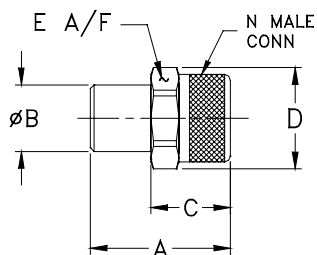

Outline Dimensions (inch/mm)

| A | B | C | D | E | wt |
|-------|-------|-------|-------|-------|-------|
| 1.18 | 0.56 | 0.67 | 0.85 | 0.787 | grams |
| 29.97 | 14.22 | 17.02 | 21.59 | 19.99 | 30.0 |



To order KARN-50+ with 3½ length chain and end coupling with .130" diameter mtg. hole, use part no. KARN-50CN+. Price is \$14.95, Qty. (1-9)

Electrical Specifications

| FREQUENCY (MHz) | IMPEDANCE (OHMS) | RETURN LOSS (dB) MIN. | | | | | POWER RATING* (W) |
|-----------------|------------------|-----------------------|----------|----------|----------|----------|-------------------|
| | | DC-.5 GHz | DC-1 GHz | DC-2 GHz | DC-4 GHz | DC-8 GHz | |
| DC-8000 | 50 | 30 | 30 | 29 | 27 | 20 | 2 |

*At 70°C, derate linearly at 0.025W/°C at 100°C.

Typical Performance Data

| Frequency (MHz) | Return Loss (dB) |
|-----------------|------------------|
| 100 | 46.31 |
| 600 | 46.36 |
| 1000 | 44.26 |
| 2000 | 39.83 |
| 3000 | 37.27 |
| 4000 | 35.14 |
| 5000 | 33.72 |
| 6000 | 34.35 |
| 7000 | 34.72 |
| 8000 | 34.96 |

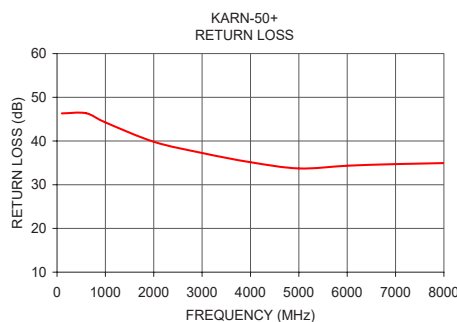

Notes

- A. Performance and quality attributes and conditions not expressly stated in this specification document are intended to be excluded and do not form a part of this specification document.
 B. Electrical specifications and performance data contained in this specification document are based on Mini-Circuit's applicable established test performance criteria and measurement instructions.
 C. The parts covered by this specification document are subject to Mini-Circuits standard limited warranty and terms and conditions (collectively, "Standard Terms"); Purchasers of this part are entitled to the rights and benefits contained therein. For a full statement of the Standard Terms and the exclusive rights and remedies thereunder, please visit Mini-Circuits' website at www.minicircuits.com/MCLStore/terms.jsp

