

# MDH-R

6.3 mm x 32 mm Ferrule and axial lead, high breaking capacity, high I<sup>2</sup>t ceramic tube fuses

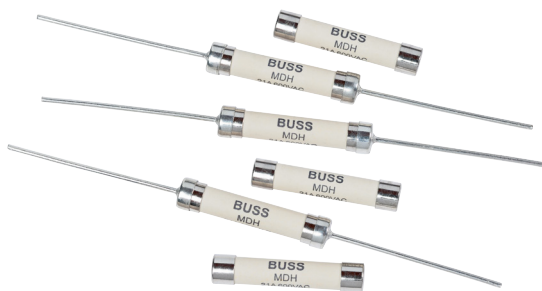

### Product description

- High breaking capacity and I<sup>2</sup>t
- High surge withstand: 20 cycles of 1.2/50  $\mu$ s - 8/20  $\mu$ s, 20 kV/10 kA surge
- UL248-14 compliant
- Ceramic tube, nickel plated brass end cap
- 6.3 mm x 32 mm form factor
- Ferrule and axial lead options
- Halogen free, lead free, RoHS compliant

### Applications

Primary circuit protection:

- Lighting controls
- Surge protectors
- LED and general lighting

### Agency information

- cURus Recognition file number: E19180, Vol 7

### Ordering

- Use ordering number (see page 3 for details)

### Packaging suffixes

- BK (100 parts per carton)
- TR (500 parts per roll)

**Electrical characteristics**

$I_n$	$1.0I_n$ min hour	$2.0I_n$ max minute
21A	4	2

**Product specifications**

Part number <sup>1</sup>								
Ferrule	Axial lead	Current rating (A)	Voltage rating (V <sub>AC</sub> )	Voltage rating (V <sub>DC</sub> )	Interrupting rating at rated AC voltage (50 Hz) (A <sub>AC</sub> )	Interrupting rating at rated DC voltage (A <sub>DC</sub> )	Typical D C cold resistance (Ω)	Typical pre-arcing <sup>1</sup> I <sup>2</sup> t (A <sup>2</sup> s)
MDH- 21-R	MDH-V- 21-R	21	600	150	200	200	0.0024	5100

1. Typical I<sup>2</sup>t value measured at 10 times of rated current under DC.

2. Part Number Definition: MDH-x-xx-R  
x = Use "V" code for axial lead, leave blank for ferrule  
xx= Ampere rating  
-R suffix = RoHS compliant

**Dimensions—mm**

Drawing not to scale

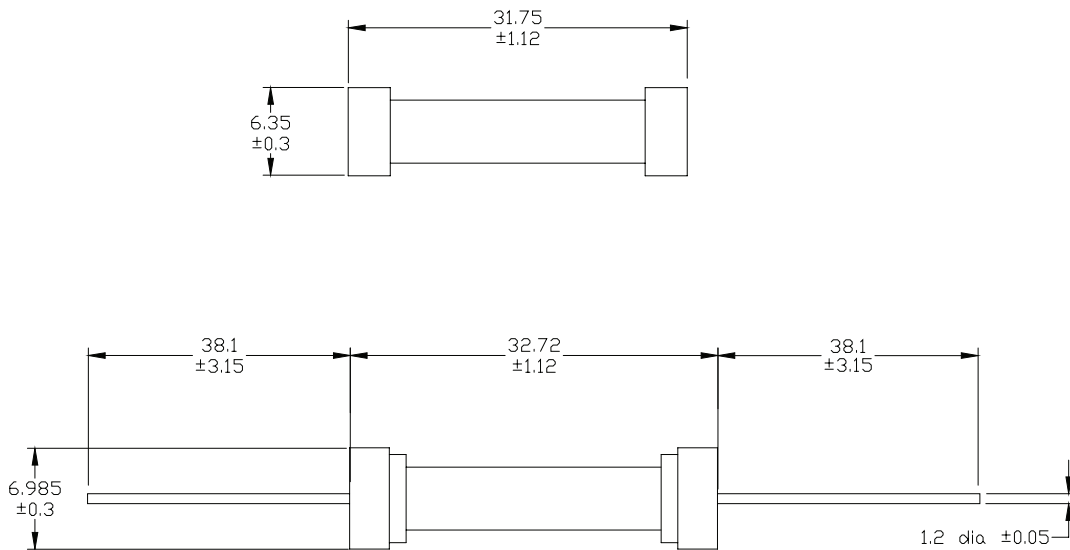

**Temperature derating curve**

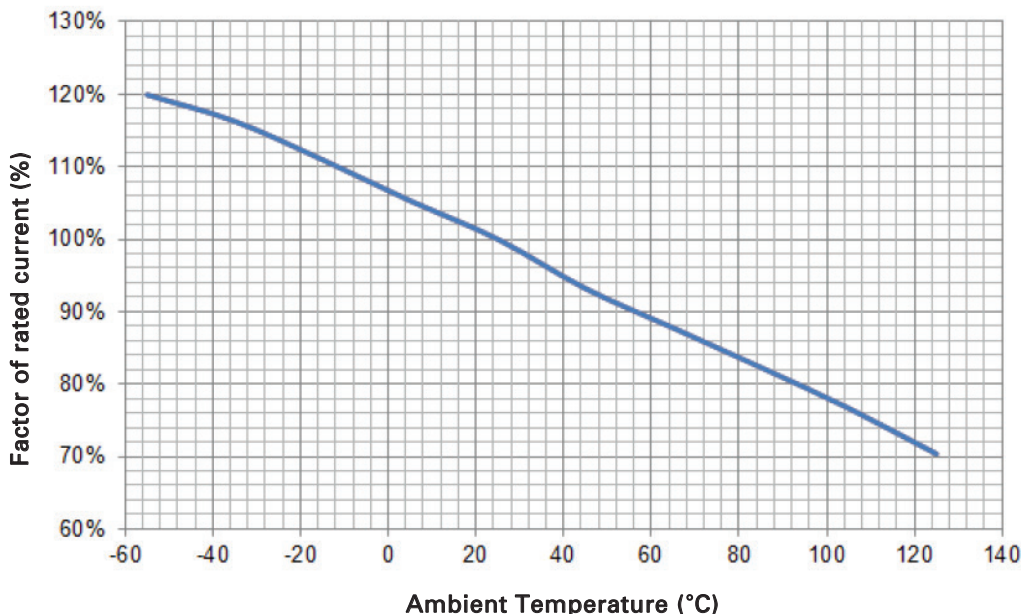

**Environmental data**

- Operating temperature: - 55 °C to 125 °C (with derating)
- Thermal shock: MIL-STD- 202G, Method 107G, test condition B (5 cycles - 65 °C to 125 °C)
- Vibration: MIL-STD- 202G, Method 201A
- Mechanical shock: MIL-STD- 202, Method 213, test condition A
- Humidity: MIL-STD- 202G, Method 103B, Test condition A
- High surge withstand: 20 cycles of 1.2/50 μs - 8/20 μs, 20 kV/10 kA surge

**Ordering codes**

The ordering code is the part number replacing the "." with a "-" plus adding the packaging suffix as shown.

**Packaging suffixes**

- BK (100 parts per carton)
- TR (500 parts per roll)

Part number	Ordering codes	
	BK option	TR option
<b>Ferrule</b>		
MDH-21-R	MDH-21-R-BK	
<b>Axial lead</b>		
MDH-V-21-R	MDH-V-21-RBK	MDH-V-21-RTR