

In case of consideration for using Automotive equipment / device which demand high reliability, kindly contact our sales window correspondents.

COUNT	DESCRIPTION OF REVISIONS	BY	CHWD	DATE	COUNT	DESCRIPTION OF REVISIONS	BY	CHWD	DATE
1	RE-J-01999	D.Y.R.K.		03.3.18					

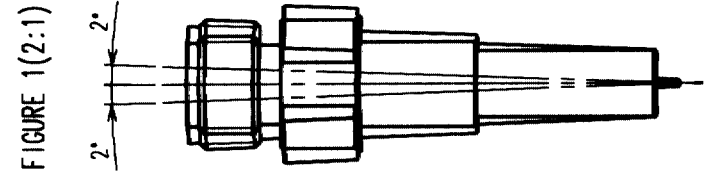
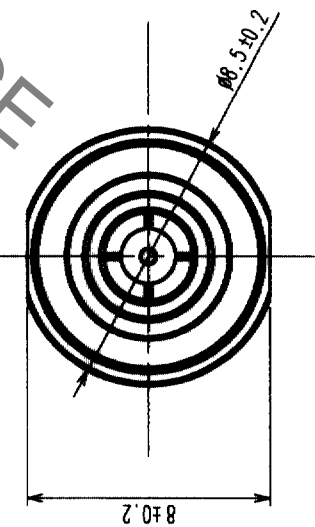
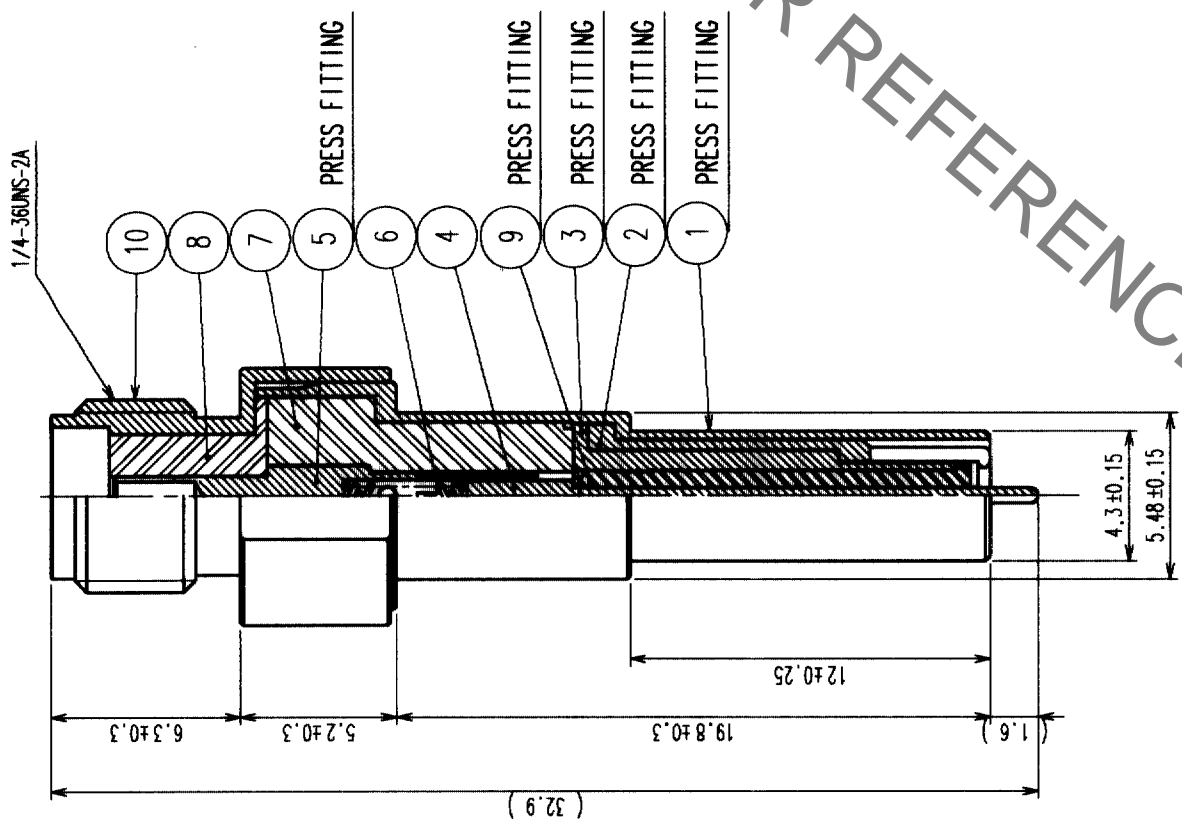
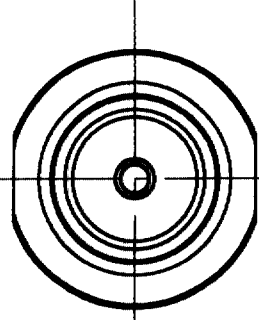

HRS DRAWING FOR REFERENCE

NO.	MATERIAL	FINISH, REMARKS	NO.	MATERIAL	FINISH, REMARKS
5	BERYLLIUM COPPER	GOLD PLATING	10	STAINLESS STEEL	PASSIVATE
4	PHOSPHOR BRONZE	GOLD PLATING	9	PTFE	
3	PHOSPHOR BRONZE	NICKEL PLATING	8	PTFE	
2	BERYLLIUM COPPER	GOLD PLATING	7	PTFE	
1	PHOSPHOR BRONZE	NICKEL PLATING	6	STAINLESS STEEL	GOLD PLATING

CODE NO. (OLD)	DESIGNED	CHECKED	APPROVED	RELEASED
	K. HIDA	K. KAWAMURA	Y. MIYAKE	
	'02.10.10	'02.10.10	'02.10.10	'02.10.11

	DRAWING NO. EDC3-180298	PART NO. MS-156-HRMJ-5
SCALE 4 : 1	CODE NO. CL358-0177-1	FORM NO. 229

NOTE 1. Use this product with MS-156 (CL358-0167-4).
 2. Mating angle must be less than ±2 degree. (refer to figure 1)

TO	
RFD	