

Sensitivity Wavelength Range: 880nm~2600nm

The MTPD2600-100 from Marktech, a high sensitivity and high reliability product series, is ideally suited for Optical Communication devices. Custom packaging options for this die is also available.

FEATURES

- > High Speed Response
- > TO-46 Metal Can Package
- > Active Area of 1.0mm Φ / High Sensitivity
- > Spectral Range 880nm - 2600nm

APPLICATIONS

- > High Speed Optical Communications
- > Industrial Controls
- > Security
- > LIDAR
- > Medical

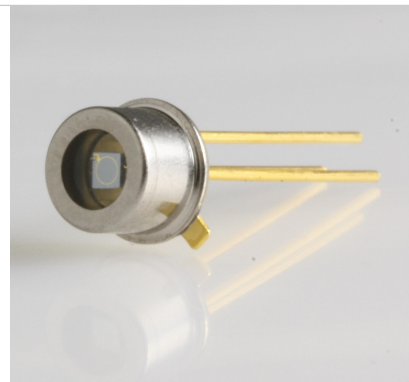

Absolute Maximum Ratings (Ta=25°C)

ITEMS	SYMBOL	RATINGS	UNIT
Active Area	Φ	1.0	mm
Operating Temperature Range	Topr	-40 to +85	°C
Storage Temperature Range	Tstg	-40 to +125	°C



Electrical & Optical Characteristics (Ta = 25°C)

ITEMS	SYMBOL	CONDITIONS	MIN	TYP	MAX	UNIT
Breakdown Voltage	VR	IR=100uA	3	--	--	V
Sensitivity Range	λ	VR=0V	880	--	2600	nm
Dark Current	ID	VR=1V	--	--	200	uA
Capacitance	C	VR=0V	--	960	--	pF
Capacitance	C	VR=1V	--	280	--	pF
Responsivity *1	R	$\lambda=1880\text{nm}$	--	1.07	--	A/W
Shunt Resistance	RS	VR=10mV	--	3.3	--	kOhm
Quantum Efficiency *1	QE	$\lambda=1860\text{nm}$	--	70	--	%
Light Current @ $\lambda=1300\text{nm}$	IL	If=10mA	--	30	--	μA
Light Current @ $\lambda=1300\text{nm}$	IL	If=20mA	--	65	--	μA

*1: As mounted on TO-46 header without resin coating or lens cap.

Package Dimensions

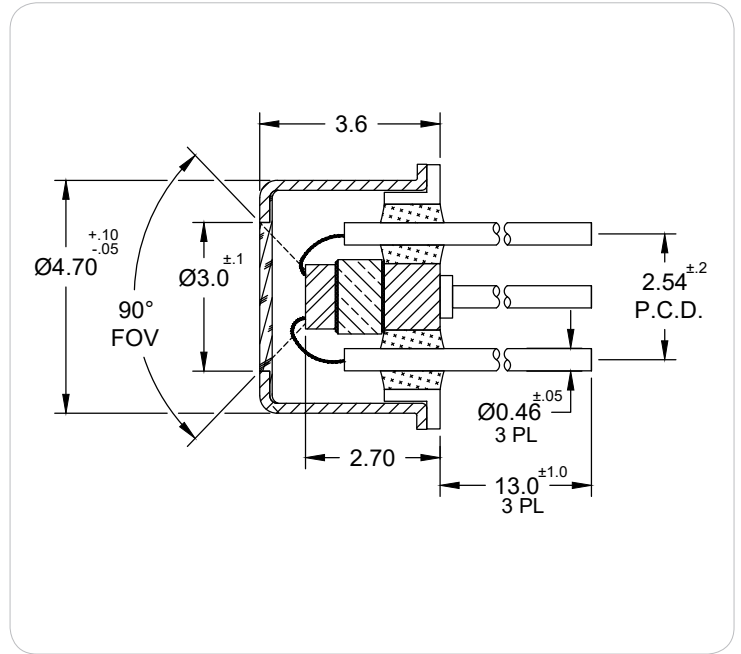
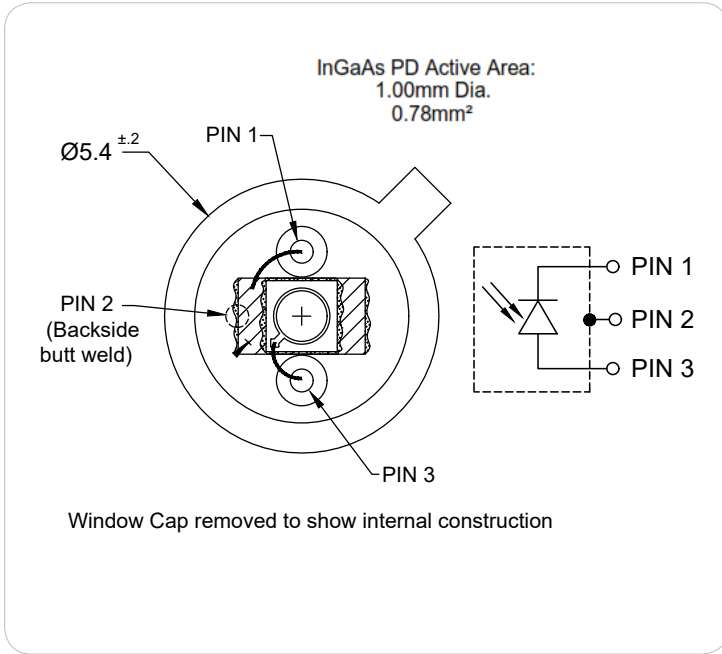

Unit: mm, Tolerance: ±0.2

The information contained herein is subject to change without notice.

2019-04-15