

| DASH NO | CABLES ACCOMMODATED | A DIM | B DIM | C FLATS | D FLATS | E DIA | ASSEMBLE PER |
|---------|--|-------|-------|---------|---------|-------|--------------|
| -7 | TRC-50-2 TRC-75-2 | 1.135 | .096 | .438 | .438 | .500 | TAI-189 |
| -8 | 8227, BELDEN | 1.716 | .130 | .625 | .688 | .750 | TAI-103 |
| -9 | TWC-78-2 TWC-124-2 | 1.135 | .096 | .438 | .438 | .500 | TAI-102 |
| -A9 | BL782, TIMES BL982, TIMES BL1242, TIMES | | | | | | |
| -10 | RG-22 754E, AT&T | 1.716 | .130 | .625 | .688 | .750 | TAI-103 |
| -11 | 760A, AT&T | | | | | | TAI-128 |
| -12 | 16 PEVL, AT&T V1-AL, GENERAL | 1.135 | .096 | .438 | .438 | .500 | TAI-129 |
| -13 | TRF-59, TIMES | | | | | | TAI-165 |
| -13A | 8232, BELDEN | 1.716 | .130 | .625 | .688 | .750 | TAI-129 |
| -14 | 8233, BELDEN | | | | | | TAI-189 |
| -23 | 250-3884, MICRODOT | 1.135 | .096 | .438 | .438 | .500 | TAI-102 |
| -24 | 202-3934, MICRODOT | | | | | | TAI-189 |
| -24A | 9530A5117, RAYCHEM | 1.716 | .130 | .625 | .688 | .750 | TAI-102 |
| -25 | T-43M, GENERAL | | | | | | TAI-189 |
| -25A | 5021HS331, RAYCHEM | 1.135 | .096 | .438 | .438 | .500 | TAI-102 |
| -26 | 7028A5518, RAYCHEM | | | | | | TAI-189 |
| -27 | T19TPSJ2619EN, WOVEN 202-3927, MICRODOT 202-3942, MICRODOT | 1.716 | .130 | .625 | .688 | .750 | TAI-102 |
| -29 | TWC-78-1/TWC-124-1A | | | | | | TAI-189 |
| -30 | 761A, AT&T 8441, BELDEN | 1.135 | .096 | .438 | .438 | .500 | TAI-102 |
| -32 | TRC-50-1 | | | | | | TAI-189 |
| -33 | TRC-75-1 | 1.716 | .130 | .625 | .688 | .750 | TAI-102 |
| -42 | 21-204, ESSEX 4463, CONSOLIDATED | | | | | | TAI-103 |
| -43 | 250-4044/250-4045 293-3930, MICRODOT | 1.135 | .096 | .438 | .438 | .500 | TAI-102 |
| -45 | M27500-22TE2T14 1100-66F, STANDARD | | | | | | TAI-189 |
| -46 | 9860, BELDEN | 1.716 | .130 | .625 | .688 | .750 | TAI-102 |
| -47 | M17/176-00002 | | | | | | TAI-189 |
| -49 | TWAC-78-1F2 | 1.135 | .096 | .438 | .438 | .500 | TAI-102 |
| -54 | 89207, BELDEN | | | | | | TAI-189 |
| -55 | 89272, BELDEN | 1.716 | .130 | .625 | .688 | .750 | TAI-102 |
| -56 | GC875GC1, GRUMMAN | | | | | | TAI-189 |
| -57 | GC875GB1, GRUMMAN | 1.135 | .096 | .438 | .438 | .500 | TAI-102 |
| -58 | GC875TM24H, GRUMMAN | | | | | | TAI-189 |
| -59 | GC875LN1, GRUMMAN | 1.716 | .130 | .625 | .688 | .750 | TAI-102 |
| -60 | M17/177, THERMATICS 380-10045, BOEING | | | | | | TAI-189 |
| -64 | 7528A5314, RAYCHEM | | | | | | |

DATA CONTAINED IN THIS DOCUMENT IS PROPRIETARY TO TROMPETER ELECTRONICS INC AND SHALL NOT BE DISCLOSED, COPIED OR USED FOR PROCUREMENT OR MANUFACTURE WITHOUT EXPRESS WRITTEN PERMISSION OF TROMPETER ELECTRONICS INC.

| REVISIONS | | 310-0025 | SH 1 |
|-----------|-----------------------|----------|----------|
| REV | DESCRIPTION | DATE | APPROVED |
| U | REVISED PER ECO 14778 | 11-5-02 | AM |

| CABLE ENTRY | | | |
|-------------|------|---------|------|
| DASH NO | DIA | DASH NO | DIA |
| -7 | .274 | -29 | .191 |
| -8 | .345 | -30 | .235 |
| -9 | .285 | -32 | .191 |
| -A9 | | -33 | .217 |
| -10 | .455 | -42 | .300 |
| -11 | .347 | -43 | .200 |
| -12 | .495 | -45 | .183 |
| -13 | .362 | -46 | .475 |
| -13A | .352 | -47 | .164 |
| -14 | .490 | -49 | .132 |
| -23 | .183 | -54 | .323 |
| -24 | .191 | -55 | .250 |
| -24A | .200 | -56 | .191 |
| -25 | .285 | -57 | |
| -25A | | -58 | .198 |
| -26 | .191 | -59 | |
| -27 | .145 | -60 | .217 |
| | | -64 | .183 |

FIG 1
-9 SHOWN

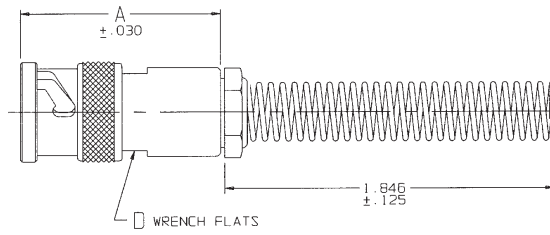
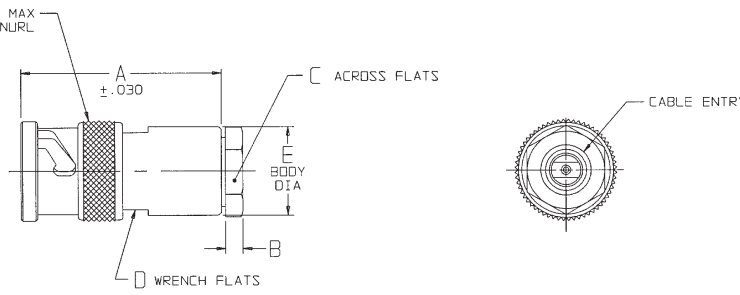

FIG 2
-9 SHOWN



RED INDICATES ORIGINAL

6. EXAMPLE OF A COMPLETE MODEL NO.

PL74 -47

BASIC MODEL NO. | DASH NO.

IF BEND RELIEF SPRING REQD (SEE FIG 1)
ADD SUFFIX "BR" TO MODEL NO
(NOT AVAILABLE WITH CABLE GROUPS -8, -10, -11,
-12, -13, -13A, -14, -46 & -54)

CLAMP NUT OMITTED
2-LUG BAYONET CONCENTRIC TWINAX/TRIAX TRB CABLE PLUG

2. FINISH: TFS-1A (NICKEL)

1. ALL DIM ARE IN INCHES

| TYPE | DASH NO/CABLE GROUP | | | | | | | | | | | | | | | | |
|---------|---------------------|-----|------|-----|-----|------|------|-----|-----|-----|-----|-----|-----|-----|-----|-----|-----|
| TWINAX | -8 | -9 | -A9 | -10 | -11 | -12 | -24 | -25 | -27 | -29 | -30 | -45 | -46 | -47 | -49 | -54 | -55 |
| TRIAx | -7 | -13 | -13A | -14 | -23 | -24A | -25A | -26 | -32 | -33 | -42 | -43 | -56 | -57 | -59 | -60 | -64 |
| QUADRAx | -58 | | | | | | | | | | | | | | | | |

| | | |
|--|--|---|
| INTERPRET DIMING PER MIL-STD-100 DIMENSIONS ARE IN INCHES UNLESS FINISH INDICATED UNLESS OTHERWISE SPECIFIED | TOL. UNLESS SPECIFIED .XX .XXX ± .005 .XXXX ± .0005 .XXXXX ± .0001 | TROMPETER RF connectivity <small>© 2003 connectivity solutions brand</small> |
| DRAWN: AAH DATE: 11-4-02 | MATERIAL: | |
| 11-4-02 | 11-4-02 | SIZE: B |
| 11-5-02 | 11-5-02 | CAGE CODE: 14949 |
| 11-4-02 | 11-4-02 | DRAWING NO: 310-0025 |
| 305-0515 | 310-0025U | SCALE: NONE |
| NEXT ASSY | 310-0025U | DATE: 3/27/78 |
| | | SHEET: 1C |