

# R-GAGE® QT50R-AFH Sensor

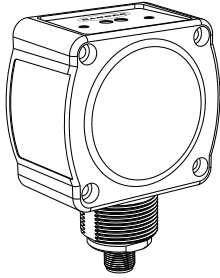

## Datasheet

Radar-Based Sensors for Detection of Moving and Stationary Targets



- FMCW radar detects moving and stationary objects
- Higher sensitivity and longer range
- Adjustable sensing field—ignores objects beyond setpoint
- Easy setup and configuration of range, sensitivity, and output with simple DIP switches
- Sensing functions are unaffected by wind, falling rain or snow, fog, humidity, air temperatures, or light
- Sensor operates in Industrial, Scientific, and Medical (ISM) telecommunication band
- Rugged IP67 housing withstands harsh environments



### WARNING:

- Do not use this device for personnel protection
- Using this device for personnel protection could result in serious injury or death.
- This device does not include the self-checking redundant circuitry necessary to allow its use in personnel safety applications. A device failure or malfunction can cause either an energized (on) or de-energized (off) output condition.

## Models

Models <sup>1</sup>	Maximum Range	Connection	Supply Voltage	Telecom Approval <sup>2</sup>	Output
QT50R-US-AFH	24 m (78 ft)	5-wire 2 m (6.5 ft) Integral cable	12 to 30 V DC	Telecom approved for US, Canada and Brazil	Bipolar NPN/PNP DIP-switch-selectable normally open (NO) or normally closed (NC)
QT50R-EU-AFH				Telecom approved for Europe, UK, Australia, New Zealand, China, and Japan	
QT50R-KR-AFH			12 to 24 V DC	Telecom approved for South Korea	
QT50R-TW-AFH			12 to 30 V DC	Telecom approved for Taiwan	
QT50R-SG-AFH				Telecom approved for Singapore	

## Overview

The R-GAGE sensor emits a well-defined beam of high-frequency radio waves from an internal antenna. Some of this emitted energy reflects back to the receiving antenna. Signal processing electronics in the sensor determine the distance from the sensor to the object based on the time delay of the return signal. The sensor can be configured (via DIP switches) to sense objects up to a specific distance, ignoring objects beyond this distance (also called background suppression).

Figure 1. R-GAGE setpoint

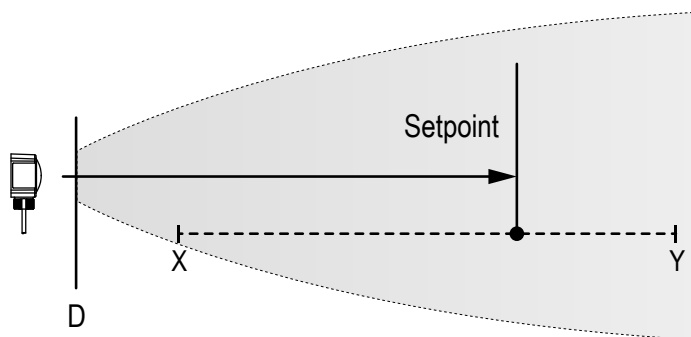

Setpoints		EU, KR Models	TW, US Models
X	Minimum setpoint distance	2 m (6.6 ft)	3.5 m (11.5 ft)
Y	Maximum setpoint distance	24 m (78.7 ft)	24 m (78.7 ft)
D	Dead Zone <sup>3</sup>		

<sup>1</sup> Cabled models only are listed. To order the integral 5-pin M12 quick-disconnect fitting, add suffix "Q" to the model number (for example, QT50R-xx-AFHQ). Quick-disconnect models require a mating cordset; see [Quick Disconnect \(QD\) Cordsets](#) on page 5.

<sup>2</sup> For additional countries, contact Banner Engineering.

<sup>3</sup> Typical dead zone: 0.4 m (1.3 ft) for moving and 1.0 m (3.3 ft) for stationary targets, but varies with target reflectivity



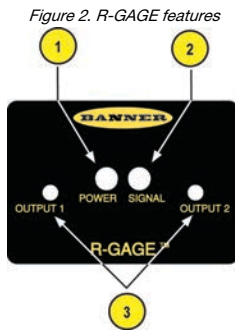

1. Power LED: Green (power ON)
  2. Signal Strength LED: Red (flashes in proportion to the signal strength)
  3. Output LEDs: Yellow (output energized); Red (configuration)
- Access the DIP switches behind the threaded cap on the sensor back (not shown)  
 R-GAGE setpoint distances, minimum and maximum (sensor will detect objects up to setpoint and ignore objects beyond the setpoint)

## Wiring

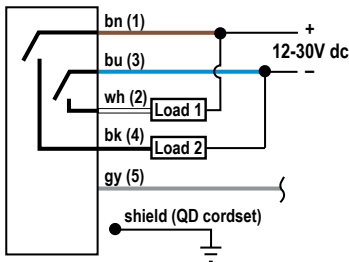

There is no connection to the gray (gy) wire.

**Note:** Banner recommends that the shield wire (quick-disconnect cordsets only) be connected to earth ground or dc common. Shielded cordsets are recommended for all quick-disconnect models.

Figure 3. M12 Male Pinout

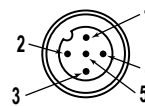

## Sensor Configuration

Configure the sensor using the DIP switches. Use the included spanner to open the screw-off cover and access the DIP switches.



**Important:** Tighten the DIP switch cover a full quarter turn after contact to maintain the watertight seal.

## DIP Switch Functions

Switch	Function
1, 2, 3	Sensing distance (detects objects from sensor face to this point)
4, 5	Sensitivity (higher sensitivity sees weaker objects and has a larger beam pattern)
6	Normally open/normally closed output functionality
7, 8	Response Speed

DIP switch 1 is on the left and DIP switch 8 is on the right.

## Distance Settings

\* Default settings

Switch 1	Switch 2	Switch 3	Distance	
			EU, KR Models	TW, US Models
0	0	0	2 m (6.6 ft)	3.5 m (11.5 ft)
0	0	1	3 m (9.8 ft)	4 m (13.1 ft)
0	1	0	4 m (13.1 ft)	5 m (16.4 ft)
0	1	1	6 m (19.7 ft)	6 m (19.7 ft)
1*	0*	0*	8 m (26.2 ft)	8 m (26.2 ft)
1	0	1	12 m (39.4 ft)	12 m (39.4 ft)
1	1	0	16 m (52.5 ft)	16 m (52.5 ft)
1	1	1	24 m (78.7 ft)	24 m (78.7 ft)



**Note:** Highest sensitivity is achieved only if sensing distance is 8 m (26.2 ft) or less.



**Note:** Near-field sensitivity boost is enabled when set to 4 m (13.1 ft) or less.

## Sensitivity Selection

Switch 4	Switch 5	Sensitivity
0*	0*	4 (Highest)
0	1	3 (High)
1	0	2 (Medium)
1	1	1 (Low)

\* Default settings



**Note:** Use the sensitivity selection to ignore unwanted weak reflections within the field of view, and not to narrow the beam width. Narrow-beam R-GAGE sensor models are available.

## Output Configuration

Switch 6	Normally Open/Normally Closed
0*	Normally open
1	Normally closed

\* Default settings

## Response Speed

Switch 7	Switch 8	On Total (ms)	Off Total (ms)	Total (ms)
0	0	30	70	100
0*	1*	50	300	350
1	0	30	1000	1030
1	1	120	6000	6120

\* Default settings

## Specifications

**Range**

The sensor is able to detect a proper object (see Detectable Objects) from 1 m to 24 m (3.3 ft to 78.7 ft), depending on target

**Detectable Objects**

Objects containing metal, water, or similar high-dielectric materials

**Operating Principle**

Frequency modulated continuous-wave (FMCW) radar

**Operating Frequency**

US, TW Models: 24.075–24.175 GHz, ISM Band  
EU, KR, SG Models: 24.050–24.250 GHz, ISM Band

**Maximum Output Power**

ERP: 3.3 mW, 5 dBm  
EIRP: 100 mW, 20 dBm

**Supply Voltage**

12 V DC to 30 V DC, less than 100 mA, exclusive of load  
For KR models: 12 V DC to 24 V DC, less than 100 mA exclusive of load

**Supply Protection Circuitry**

Protected against reverse polarity and transient overvoltages

**Delay at Power-up**

Less than 2 seconds

**Output Configuration**

Bipolar NPN/PNP output, 150mA; DIP switch 6 selects N.O. (default) or N.C. operation

**Output Protection**

Protected against short circuit conditions

**Response Time**

DIP switches 7 & 8 select ON/OFF response time

Complies with  
IMDA Standards  
N1455-15

**Indicators**

**Power LED:** Green (power ON)

**Signal Strength LED:** Red, flashes in proportion to signal strength. Steady on at 4x excess gain. Only indicates signal amplitude, not target distance.

**Output LEDs:** Yellow (output energized) / Red (configuration)

See Figure 2 on page 2

**Adjustments**

DIP-switch-configurable sensing distance, sensitivity, response time, and output configuration

**Construction**

**Housing:** ABS/polycarbonate

**Lightpipes:** Acrylic

**Access Cap:** Polyester

**Operating Temperature**

–40 °C to +65 °C (–40 °F to +149 °F)

**Environmental Rating**

IP67

**Connections**

Integral 5-wire 2 m (6.5 ft) cable or M12 quick disconnect fitting. Quick disconnect models require a mating cordset

**Certifications**

ETSI/EN 300 440  
FCC part 15,  
RSS-210  
ANATEL Category II  
CMIIT Category G  
ARIB STD T-73  
KC mark - MSIP/RRA  
NCC  
IDA Singapore  
for others, contact Banner Engineering  
Country of Origin: USA

FCC ID: UE3QT50RUS— This equipment has been tested and found to comply with the limits for a Class A digital device, pursuant to part 15 of the FCC Rules. These limits are designed to provide reasonable protection against harmful interference when the equipment is operated in a commercial environment. This equipment generates, uses, and can radiate radio frequency energy and, if not installed and used in accordance with the instruction manual, may cause harmful interference to radio communications. Operation of this equipment in a residential area is likely to cause harmful interference in which case the user will be required to correct the interference at his own expense.

IC: 7044A-QT50RCA—This device contains licence-exempt transmitters(s)/receiver(s) that comply with Innovation, Science and Economic Development Canada's licence-exempt RSS(s). Operation is subject to the following two conditions:

1. This device may not cause interference.
2. This device must accept any interference, including interference that may cause undesired operation of the device.

Cet appareil contient des émetteurs/récepteurs exemptés de licence conformes à la norme Innovation, Sciences, et Développement économique Canada. L'exploitation est autorisée aux deux conditions suivantes:

1. L'appareil ne doit pas produire de brouillage.
2. L'utilisateur de l'appareil doit accepter tout brouillage radioélectrique subi, même si le brouillage est susceptible d'en compromettre le fonctionnement.



Este equipamento não tem direito à proteção contra interferência prejudicial e não pode causar interferência em sistemas devidamente autorizados.

SRD24-IO3B24100.2TR0.1 South Korea Class A Certification  
A 급 기기 ( 업무용 방송통신기자재 )

이 기기는 업무용 (A 급) 으로 전자파적합기기로  
서 판매자 또는 사용자는 이 점을 주의하시기  
바라며, 가정외의 지역에서 사용하는 것을 목  
적으로 합니다.

Beam Pattern

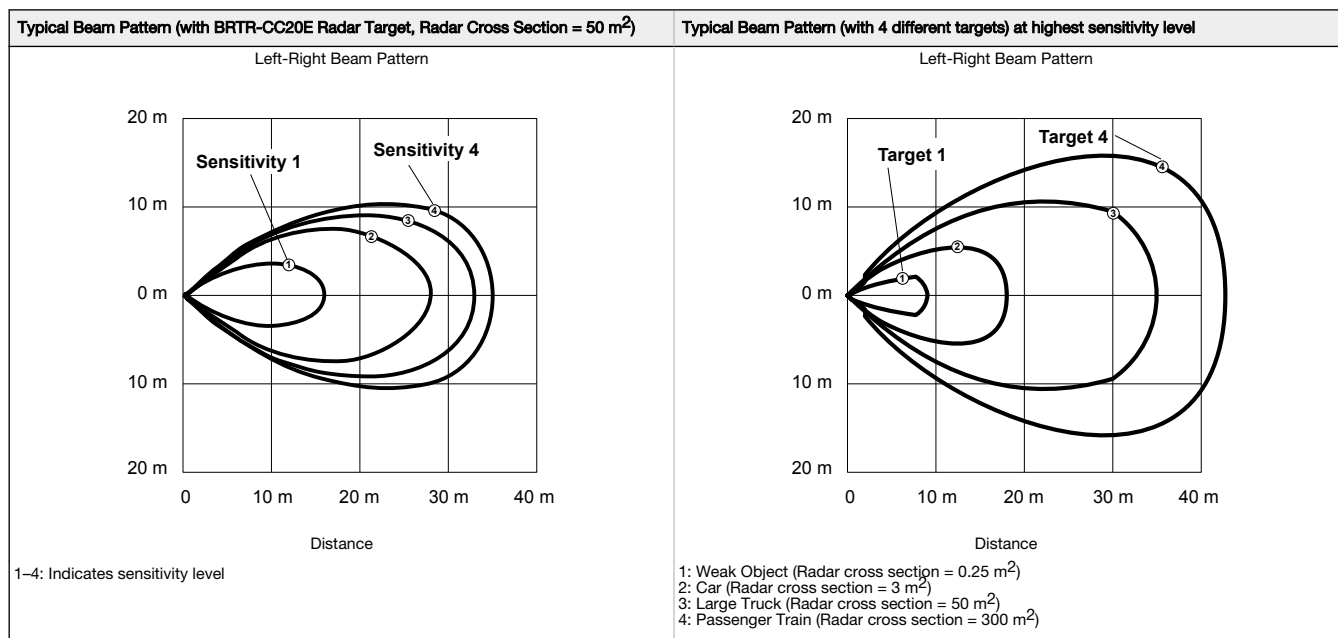

**Note:** The effective beam pattern depends on the sensitivity level and target properties.

## Dimensions

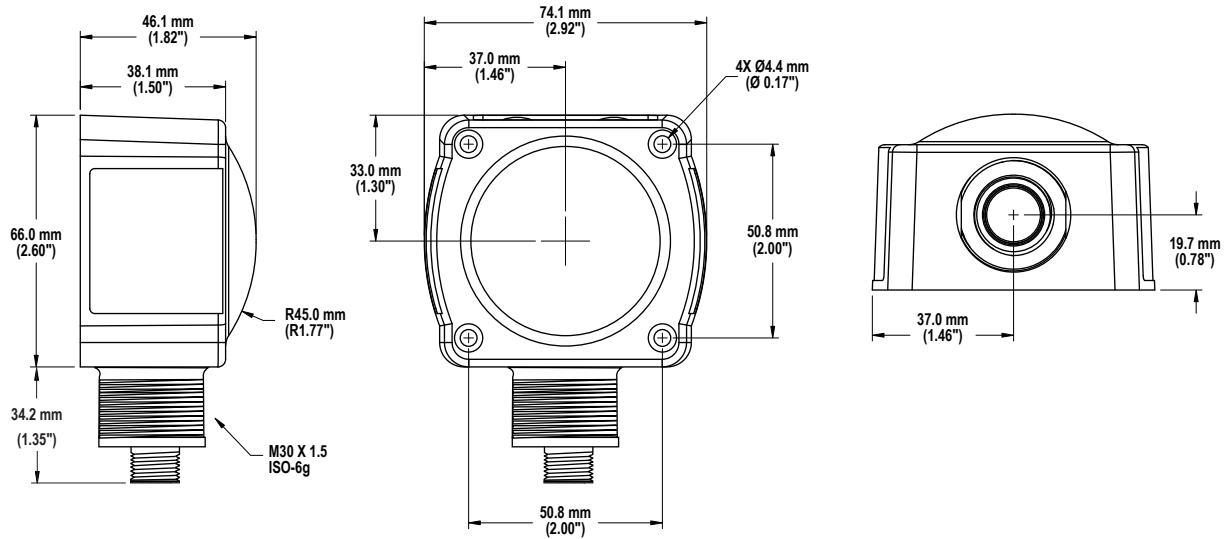

## Windows

The R-GAGE sensor can be placed behind a glass or a plastic window, but the configuration must be tested and the distance from the sensor to the window must be determined and controlled prior to installation. There is typically a 20% signal reduction when the sensor is placed behind a window.

Polycarbonate at 4 mm thickness performs well in most situations, but the performance depends on filler materials. Thinner (1 to 3 mm) windows have high reflection. The amount of reflection depends on the material, thickness, and distance from the sensor to the window.

Locate the sensor in a position of minimum reflection from the window, which will repeat every 6.1 mm of distance between the sensor and the window. The positions of maximum reflection from the window repeat between the minimums, and decrease in effect until the window is approximately 150 mm (5.9 in) away. Consult the factory for pre-tested window materials which can be used at any distance without issue.

Additionally, the face of the window should be protected from flowing water and ice by use of a flow diverter or hood directly above the window. Falling rain or snow in the air in front of the window, light water mist, or small beads on the face of the window are typically not an issue. However, a thick, continuous surface of water or ice directly on the face of the window can be detected as a dielectric boundary.

## Accessories

### Quick Disconnect (QD) Cordsets

5-Pin Threaded M12 Cordsets with Shield—Single Ended				
Model	Length	Style	Dimensions	Pinout (Female)
MQDEC2-506	2 m (6.56 ft)	Straight		<p>1 = Brown 2 = White 3 = Blue 4 = Black 5 = Gray</p>
MQDEC2-515	5 m (16.4 ft)			
MQDEC2-530	9 m (29.5 ft)			
MQDEC2-550	15 m (49.2 ft)	Right-Angle		
MQDEC2-506RA	2 m (6.56 ft)			
MQDEC2-515RA	5 m (16.4 ft)			
MQDEC2-530RA	9 m (29.5 ft)			
MQDEC2-550RA	15 m (49.2 ft)			



**Note:** Pin 5 is not used.