

PAGE 1/4	ISSUE 20-03-17E	SERIES SBMA	PART NUMBER R108294000
----------	-----------------	-------------	------------------------

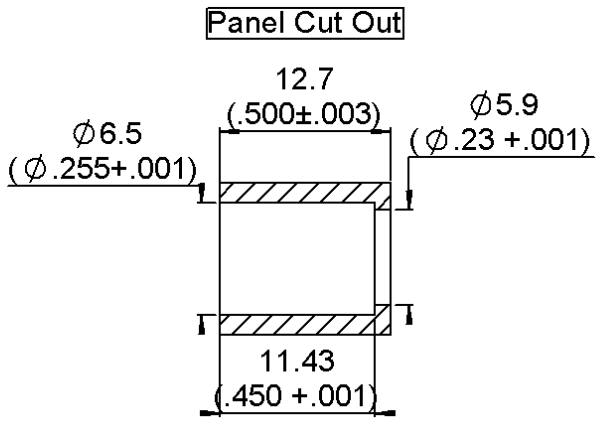

All dimensions are in mm.

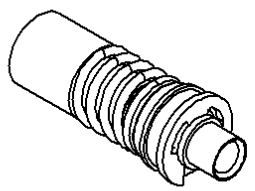
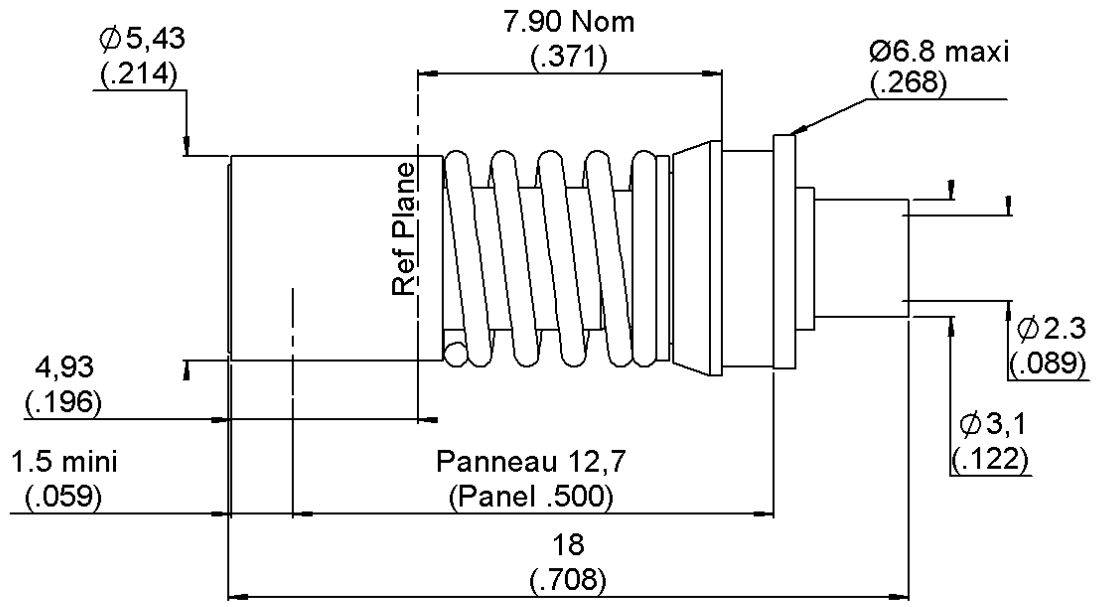
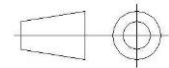

COMPONENTS	MATERIALS	PLATING (µm)
Body	STAINLESS STEEL	GOLD OVER NICKEL
Center contact	BERYLLIUM COPPER	GOLD OVER NICKEL
Outer contact	BERYLLIUM COPPER	GOLD OVER NICKEL
Insulator	PTFE	
Gasket	-	
Others parts	BERYLLIUM COPPER	NICKEL
-	-	-
-	-	-

PAGE 2/4	ISSUE 20-03-17E	SERIES SBMA	PART NUMBER R108294000
-----------------	------------------------	--------------------	-------------------------------

PACKAGING

Standard	Unit	Other
1		Contact us

ELECTRICAL CHARACTERISTICS

Impedance	50	Ω
Frequency	0-28	GHz
VSWR	1.05 + 0,0100	x F(GHz) Maxi
Insertion loss	.04	√F(GHz) dB Maxi
RF leakage	90	- F(GHz)) dB Maxi
Voltage rating	250	Veff Maxi
Dielectric withstanding voltage	675	Veff mini
Insulation resistance	5000	MΩ mini

MECHANICAL CHARACTERISTICS

Center contact retention		
Axial force – Mating End	18.1	N mini
Axial force – Opposite end	18.1	N mini
Torque	NA	N.cm mini
Recommended torque		
Mating	NA	N.cm
Panel nut	NA	N.cm
Clamp nut	NA	N.cm
A/F clamp nut	0,0000	mm
Mating life	1000	Cycles mini
Weight	1,6000	g

ENVIRONMENTAL

Operating temperature	-65/+105	°C
Hermetic seal	NA	Atm.cm3/s
Panel leakage	NA	

SPECIFICATION

CABLE ASSEMBLY

Stripping	a	b	c	d	e	f
mm	1,78	0	0	0	0	0

Assembly instruction:

Recommended cable(s)

KS 1
RG 405

Characteristics indicated on this data sheet are those that can be achieved with the highest performance cable. Intrinsic limitations of the cable may diminish the performance of the assembly

Cable retention

- pull off	200	N mini
- torque	NA	N.cm

TOOLING

Part Number	Description	Hexagon
R282051000	STRIPPING TOOL	Denudage
R282062000	POINTER GAUGE	Appointage (ame cable)
R282740000	SOLDERING MOUNTING	Soudure (support)

OTHER CHARACTERISTICS

-

PAGE 3/4	ISSUE 20-03-17E	SERIES SBMA	PART NUMBER R108294000
----------	-----------------	-------------	------------------------

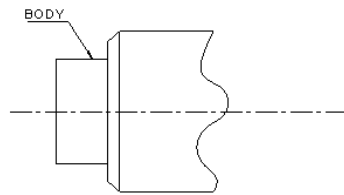

We recommend a cable thermal preconditioning before assembly

1
1-1 strip the cable.
 Stripping tool R282.051.000
 Positioner R282.062.000

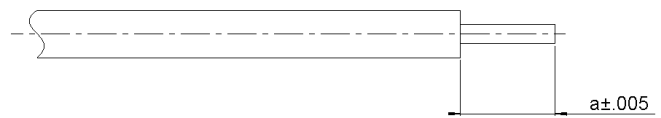

Stripping	a	b	c	d	e
inch	.070	-	-	-	-
mm	1.78	-	-	-	-

2
2-1 Trim cable centre conductor
 Trimmer R282.062.000

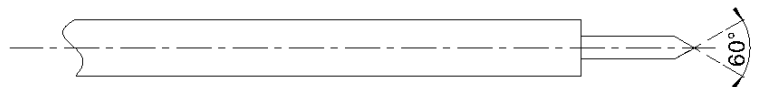

3
3-1 Introduce the cable into the Connector body until contact with the Body shoulder. Place the sub assembly into the assembly Jip R282.740.000 (or equivalent) with positioner R282.860.120 and tighten it.
3-2 Solder body on the cable.
3-3 Let the assembly cool down before Removing it from the Jig.

