

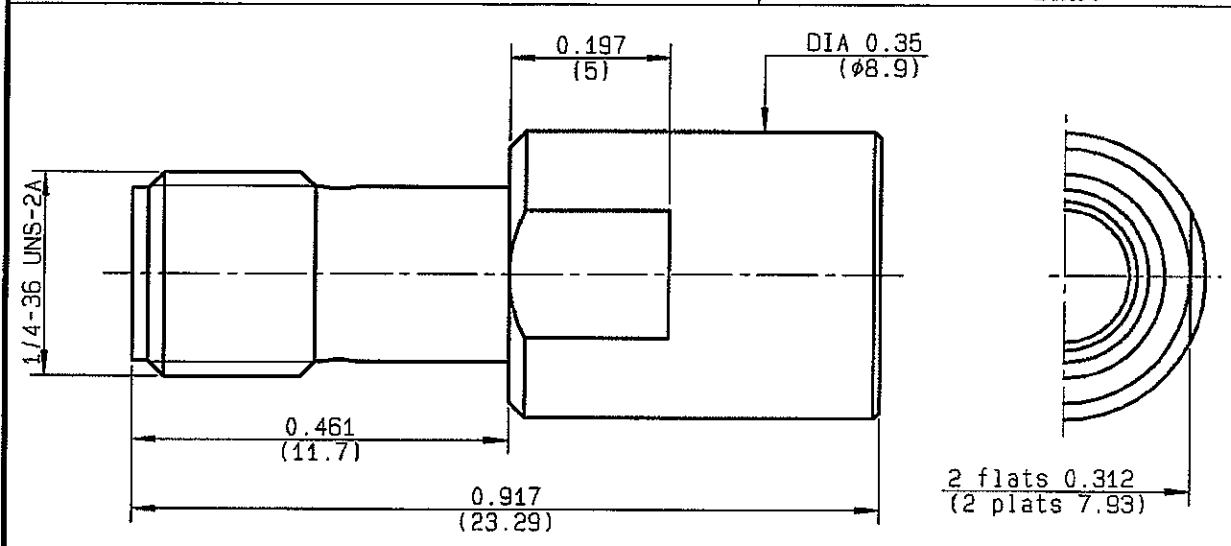

<b>MALE-FEMALE ADAPTOR PUSH-ON</b>	<b>R125.791.501</b>
	<b>SERIES SMA</b>



NOMINAL IMPEDANCE	50 $\Omega$	CABLES :
FREQUENCY RANGE	0-18 GHz	
TEMPERATURE RATING	-65/+165 °C	
V.S.W.R	1.08 + 0.01 x F(GHz)Maxi	
RF INSERTION LOSS	0.07 $\sqrt{F}$ (GHz) dB Maxi	
VOLTAGE RATING	500 Veff Maxi	
DIELECTRIC WITHSTANDING VOLTAGE	1000 Veff Mini	
INSULATION RESISTANCE	5000 M $\Omega$ Mini	OTHERS CHARACTERISTICS
HERMETIC SEAL	NA Atm.cm <sup>3</sup> /s	CABLE RETENTION
LEAKAGE (pressurized only)	NA	CENTER CONTACT RETENTION
MECHANICAL DURABILITY	500 Cycles	Axial force - mating end
WEIGHT	gr	Axial force - opposite end
SPECIFICATION		Torque
		RECOMMENDED TORQUES
		Mating
		Panel nut
		Clamp nut

CONNECTOR PARTS:	MATERIALS	FINISH (all values are given in micrometers)
BODY	STAINLESS STEEL	PASSIVATED .
OUTER CONTACT	BERYLLIUM COPPER	NICKEL 2
CENTER CONTACT	BERYLLIUM COPPER	GOLD 2.54 OVER NICKEL 2
INSULATOR	PTFE	-
GASKET		-
OTHERS PIECES		

ISSUE <b>0549 C</b>	CREATION DATE <b>12/04/1994</b>	FILE PART-NUMBER <b>94-0400-052</b>	 <b>RADIALL®</b>
------------------------	------------------------------------	--	--

The information given here is subject to change without notice. Design changes may be in order to improve the product.

*Connect to the future*

MASTRAND