

## STRAIGHT PLUGS, EZ FIT TYPE, FOR CORRUGATED CABLES

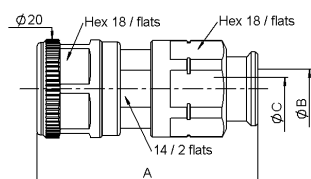

Fig. 1

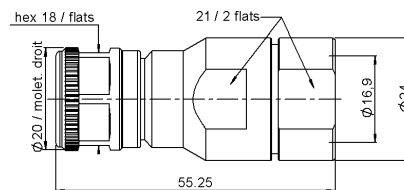

Fig. 2

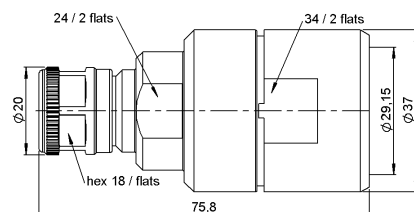

Fig. 3

Cable group	Part number	Fig.	Dimensions (mm)			Captured center contact	Assembly instructions
			A	B	C		
1/4" superflexible corrugated	R161 036 007	1	44.7	7.95	4.7	yes	M18
3/8" superflexible corrugated	R161 036 207	1	45.1	11	7.1	yes	M18
1/2" flexible corrugated	R161 091 020W	2				yes	M19
1/2" superflexible corrugated	R161 037 020	1	45.1	14	8.8	yes	M18
7/8" flexible corrugated	R161 033 020W	3				yes	M20

## STRAIGHT PLUGS, FOR SEMI-RIGID CABLES

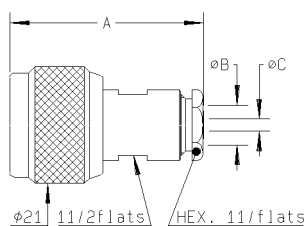
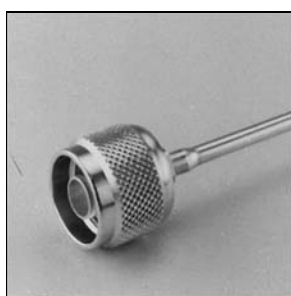

Fig. 1

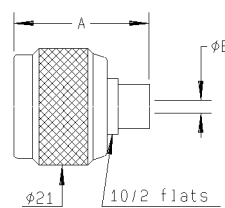

Fig. 2

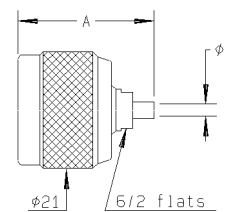

Fig. 3

Cable group	Part number	Fig.	Dimensions (mm)			Captured center contact	Assembly instructions	Note
			A	B	C			
.141"	R161 051 000	3	24.4	3.65		no	M07	Solder type
.141"	R161 052 000	1	35	5.6	3.65	no	M06	Clamp type
.250"	R161 053 000	1	35.4	6.6		no	M06	Clamp type
.250"	R161 054 000	2	24.4	6.45		no	M07	Solder type