

STRAIGHT PLUGS, FULL CRIMP TYPE, FOR FLEXIBLE CABLES

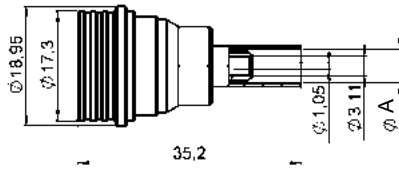

Fig. 1

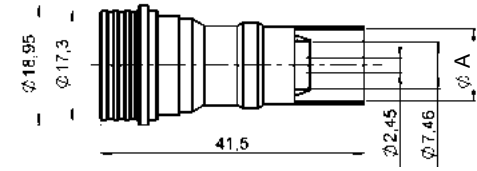

Fig. 2

cable group	part number	fig.	A	captured center contact	assembly instructions	packaging
5/50/S	R164 075 000	1	5.41	no	M01	50 pieces (*)
5/50/D	R164 076 000	1	5.8	no	M01	
10/50/S	R164 080 000	2	11.05	no	M01	
11/50/D	R164 088 000	2	11.4	no	M01	

STRAIGHT PLUGS, SOLDER TYPE, FOR SEMI RIGID CABLES

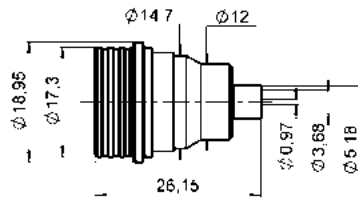

Fig. 1

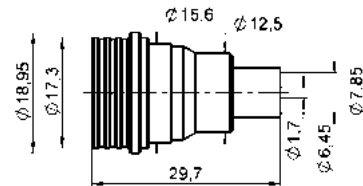

Fig. 2

cable group	part number	fig.	captured center contact	assembly instructions	packaging
.141"	R164 051 002	1	yes	M03	50 pieces (*)
.250"	R164 054 002	2	no	M04	

STRAIGHT PLUGS, EZ FIT TYPE, FOR CORRUGATED CABLES

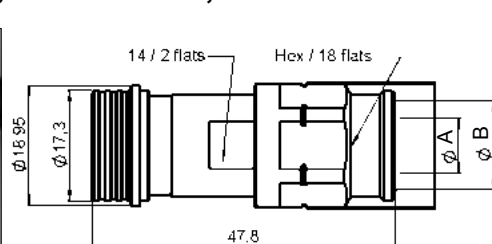

Fig. 1

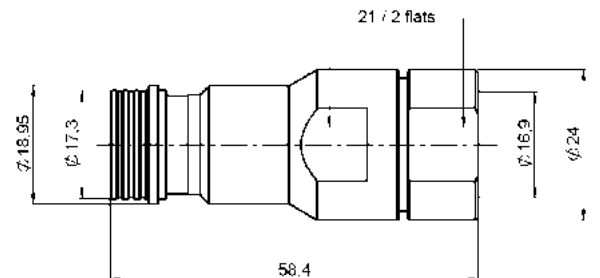

Fig. 2

cable	part number	fig.	Dimensions		captured center contact	assembly instructions	packaging
			A	B			
3/8" superflexible corrugated	R164 036 000	1	7.1	11	yes	M07	unit
1/2" superflexible corrugated	R164 037 000	1	8.8	14	yes	M07	unit
1/2" flexible corrugated	R164 091 000	2	-	-	yes	M08	unit

(*) For unit packaging, add "W" after the P/N.