

PAGE 1/3	ISSUE 11-12-14B	SERIES HN	PART NUMBER R176027520
----------	-----------------	-----------	------------------------

Position du contact central non conforme cahier des charges mais compatible
Mating dimensional characteristics out of standard but compatible

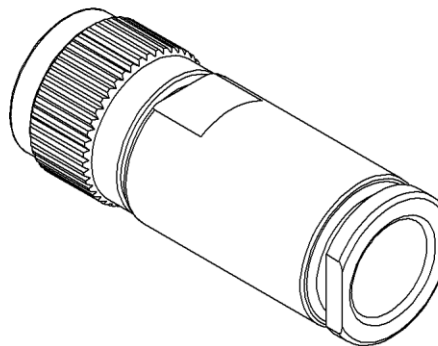

All dimensions are in mm.

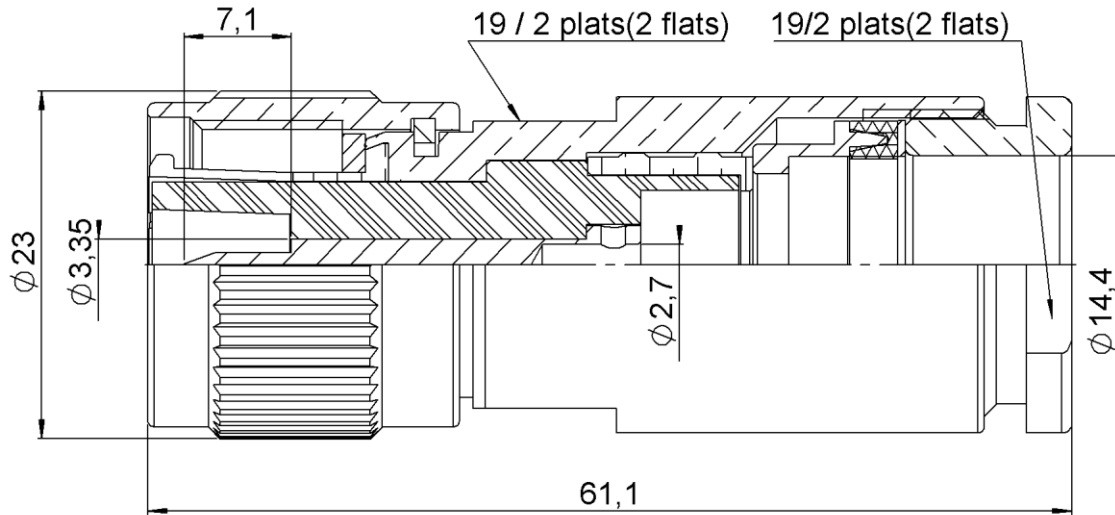
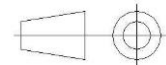

COMPONENTS	MATERIALS	PLATING (µm)
Body	BRASS	NICKEL .
Center contact	BRASS	SILVER 5 OVER COPPER 0.5
Outer contact	BRASS	NICKEL .
Insulator	PTFE	
Gasket	SILICONE RUBBER	
Others parts	BRASS	NICKEL .
-	-	-
-	-	-

PAGE 2/3	ISSUE 11-12-14B	SERIES HN	PART NUMBER R176027520
-----------------	------------------------	------------------	-------------------------------

PACKAGING

Standard 1	Unit Contact us	Other Contact us
----------------------	---------------------------	----------------------------

ELECTRICAL CHARACTERISTICS

Impedance	50	Ω
Frequency	0-3	GHz
VSWR	NA + 0,0000	x F(GHz) Maxi
Insertion loss	NA	\sqrt{F} (GHz) dB Maxi
RF leakage	- (NA)	- F(GHz)) dB Maxi
Voltage rating	1500	Veff Maxi
Dielectric withstanding voltage	*5000	Veff mini
Insulation resistance	**5000	M Ω mini

MECHANICAL CHARACTERISTICS

Center contact retention		
Axial force – Mating End	NA	N mini
Axial force – Opposite end	NA	N mini
Torque	NA	N.cm mini
Recommended torque		
Mating	NA	N.cm
Panel nut	NA	N.cm
Clamp nut	800	N.cm
A/F clamp nut	19,0000	mm
Mating life	500	Cycles mini
Weight	112,0700	g

ENVIRONMENTAL

Operating temperature	-55/+155	$^{\circ}\text{C}$
Hermetic seal	NA	Atm.cm3/s
Panel leakage	NA	

SPECIFICATION

CABLE ASSEMBLY

Stripping	a	b	c	d	e	f
mm	6	16.5	0	0	7.5	0

Assembly instruction:

Recommended cable(s)

Characteristics indicated on this data sheet are those that can be achieved with the highest performance cable. Intrinsic limitations of the cable may diminish the performance of the assembly

Cable retention

- pull off	800	N mini
- torque	NA	N.cm

TOOLING

Part Number	Description	Hexagon
.	.	.

*5000Veff during 1 min
*with leakage current < 1mA
**5000MOhms under 500 Vdc