

PC7

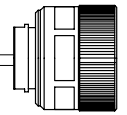

To SSMA

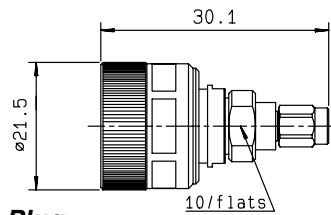

Plug

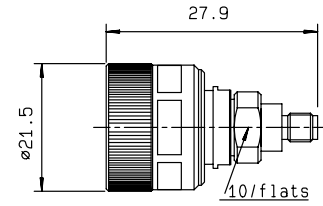

Jack

Part number	type	Frequency	V.S.W.R. max
R191 033 000●	plug	DC - 18 GHz	1.04 + 0.006 F (GHz)
R191 035 000●	jack		

To SBMA

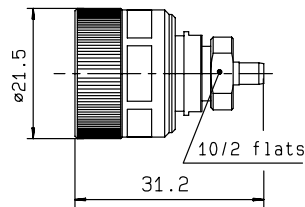

Plug

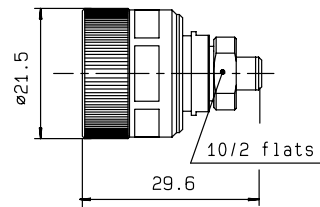

Jack

Part number	type	Frequency	V.S.W.R. max
R191 045 000●	plug	DC - 18 GHz	1.03 + 0.007 F (GHz)
R191 047 000●	jack		

To MCX

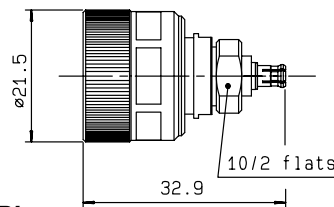

Plug

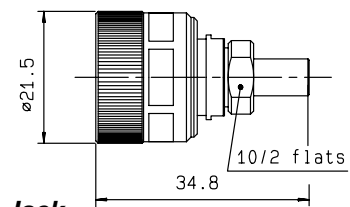

Jack

Part number	type	Frequency	V.S.W.R. max
R191 041 000●	plug	DC - 6 GHz	1.05 + 0.01 F (GHz)
R191 043 000●	jack		

To SMA or SMA 3.5

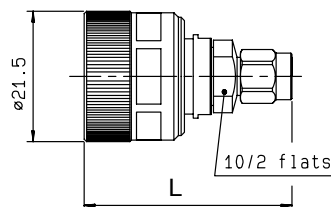

Plug

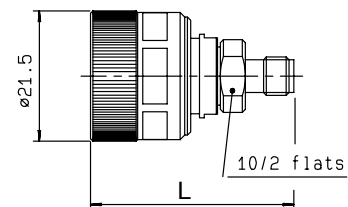

Jack

Part number	Serie	type	length	Frequency	V.S.W.R. max
R191 009 000	SMA	plug	26.8	DC - 18 GHz	1.03 + 0.0025F(GHz)
R191 011 000		jack	25.9		
R191 010 000	SMA 3.5	plug	34.1		1.05 + 0.005F (GHz)
R191 012 000		jack	33.1		

● Upon request