

ADAPTOR BNC JACK - MQ PLUG

R191.413.000

Série : ADAPT

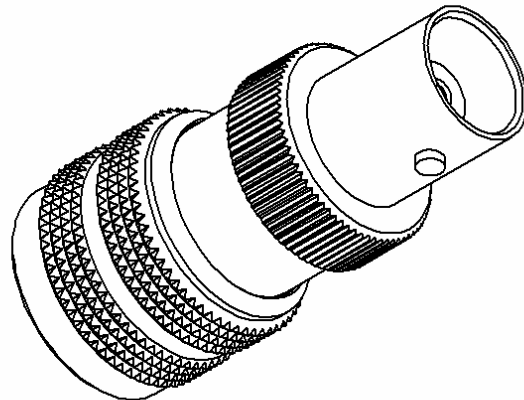
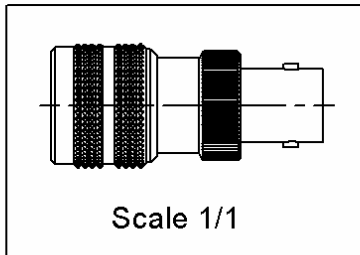
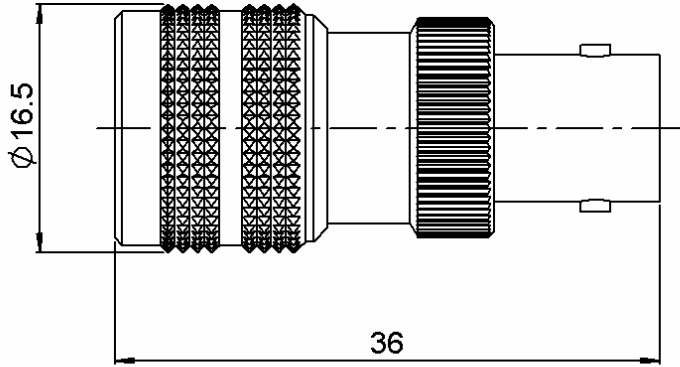

All dimensions are in mm.

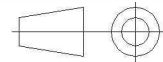

COMPONENTS	MATERIALS	PLATING (µm)
BODY	BRASS	WHITE CHROMNIUM OVER NICKEL
CENTER CONTACT	BERYLLIUM COPPER	SILVER OVER COPPER
OUTER CONTACT	-	-
INSULATOR	PTFE	-
GASKET	SILICONE	-
OTHERS PARTS	BRASS	WHITE CHROMNIUM OVER NICKEL
-	-	-
-	-	-

Issue : 1143 X

In the effort to improve our products, we reserve the rights to make changes judged to be necessary.



ADAPTOR BNC JACK - MQ PLUG

R191.413.000

Série : ADAPT

PACKAGING

Standard	Unit	Other
1	-	Contact us

SPECIFICATION

ELECTRICAL CHARACTERISTICS

Impedance	50	Ω
Frequency	0-4	GHz
VSWR	1.20 + 0,0000	x F(GHz) Maxi
Insertion loss	0.115	\sqrt{F} (GHz) dB Maxi
RF leakage	- (57)	- F(GHz)) dB Maxi
Voltage rating	500	Veff Maxi
Dielectric withstanding voltage	1500	Veff mini
Insulation resistance	5000	M Ω mini

ENVIRONMENTAL

Operating	-40°+100°	° C
Hermetic seal	NA	Atm.cm3/s
Panel leakage	NA	

MECHANICAL CHARACTERISTICS

Center contact retention		
Axial force – Mating end	27	N mini
Axial force – Opposite end	27	N mini
Torque	NA	N.cm mini
Recommended torque		
Mating	BNC	0 N.cm
	MQ	0 N.cm
	-	0 N.cm
Panel nut	NA	N.cm
Mating life	500	Cycles mini
Weight	28,0000	g

OTHER CHARACTERISTICS

Issue : 1143 X

In the effort to improve our products, we reserve the rights to make changes judged to be necessary.

