

PAGE 1/2	ISSUE 1317	SERIES ADAPT-MES	PART NUMBER R191555000
----------	------------	------------------	------------------------

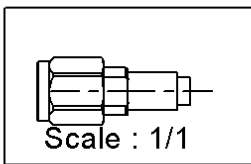

All dimensions are in mm.

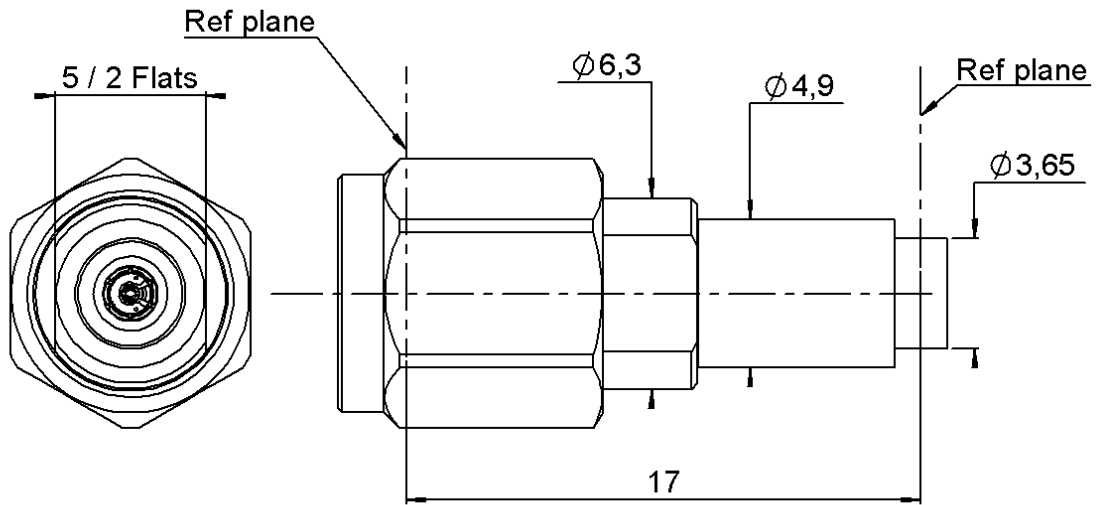
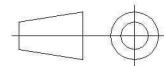

COMPONENTS	MATERIALS	PLATING (μm)
Body	BERYLLIUM COPPER	GOLD 1.3 OVER NICKEL2
Center contact	BERYLLIUM COPPER	NPGR
Outer contact	BERYLLIUM COPPER	GOLD 1.3 OVER NICKEL2
Insulator	PEEK	
Gasket	-	
Others parts	BERYLLIUM COPPER	NICKEL 2
-	-	-
-	-	-

PAGE 2/2	ISSUE 1317	SERIES ADAPT-MES	PART NUMBER R191555000
-----------------	-------------------	-------------------------	-------------------------------

PACKAGING

Standard	Unit	Other
UNITAIRE	-	Contact us

ELECTRICAL CHARACTERISTICS

Impedance		50		Ω
Frequency		0-40		GHz
VSWR	1.05	+	0,0040	x F(GHz) Maxi
Insertion loss			0.25	√F(GHz) dB Maxi
RF leakage		-	NA	- F(GHz) dB Maxi
Voltage rating			335	Veff Maxi
Dielectric withstanding voltage			500	Veff mini
Insulation resistance			5000	MΩ mini

ENVIRONMENTAL

Operating	-65/+175	°C
Hermetic seal		Atm.cm3/s
Panel leakage		

MECHANICAL CHARACTERISTICS

Center contact retention				
Axial force – Mating End		7		N mini
Axial force – Opposite end		7		N mini
Torque		NA		N.cm mini
Recommended torque				
Mating		95		N.cm
		0		N.cm
		0		N.cm
Panel nut				N.cm
Mating life		500		Cycles mini
Weight		4,0900		g

SPECIFICATION

OTHER CHARACTERISTICS