

STANDARD SERIES ADAPTERS

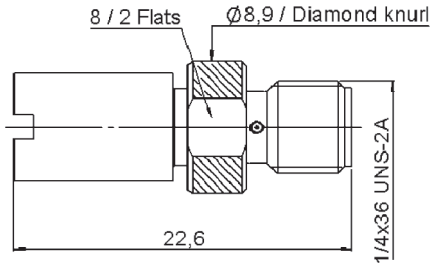

Part number	Interface
R191 368 020	1.0/2.3 Male - SMA Female

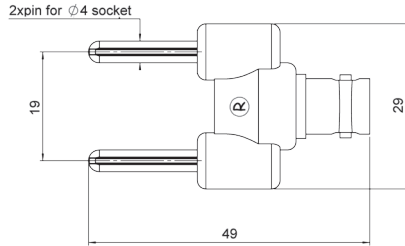

Part number	Interface
R191 455 000	2B4 Male - BNC Female

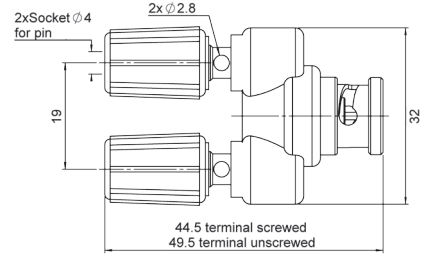

Part number	Interface
R191 453 000	2B4 Female - BNC Male

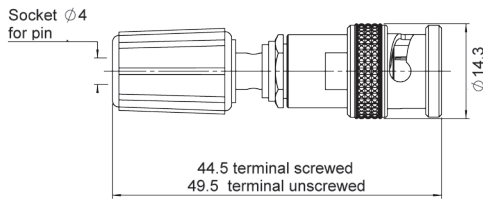

Part number	Interface
R191 454 000	2B4 Female - BNC Male

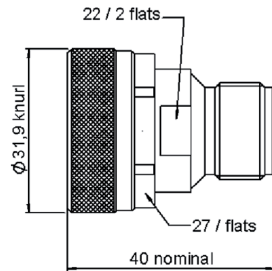

Part number	Interface
R191 907 000	7/16 Male - HN Female

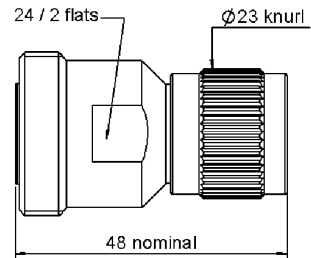

Part number	Interface
R191 908 000	7/16 Female - HN Male

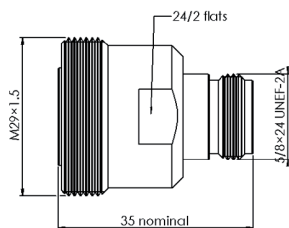

Part number	Interface
R191 723 000	7/16 Female - N Female

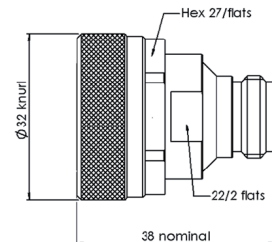

Part number	Interface
R191 722 000	7/16 Male - N Female

# STANDARD SERIES ADAPTERS

ADAPTERS 50Ω

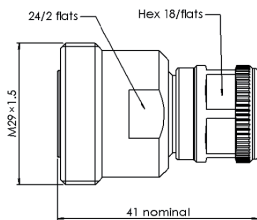

Part number	Interface
R191 720 000	7/16 Female - N Male

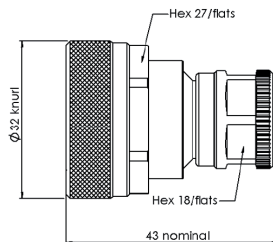

Part number	Interface
R191 721 000	7/16 Male - N Male

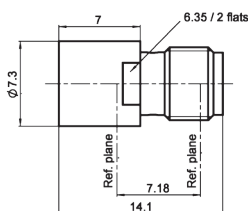

Part number	Interface
R191 353 711	BMA Female - SMA Female

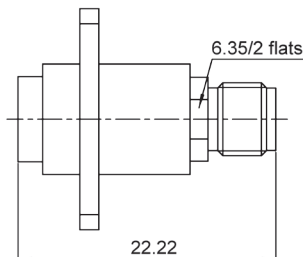

Part number	Interface	Panel drilling
R191 353 701	BMA Female - SMA Female	P12

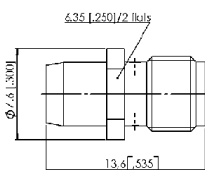

Part number	Interface
R191 352 001	BMA Male - SMA Female

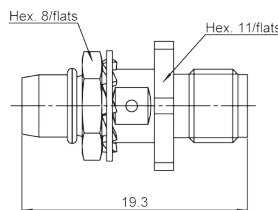

Part number	Interface	Panel drilling
R191 355 001	BMA Male - SMA Female	P03

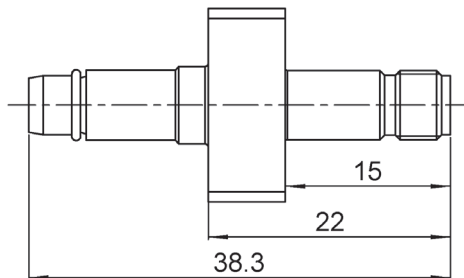

Part number	Interface	Panel drilling
R191 352 L00	BMA Male - SMA Female	P09

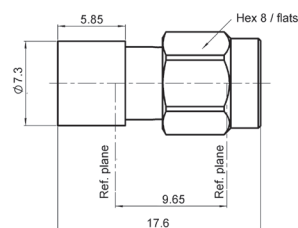

Part number	Interface
R191 351 701	BMA Female - SMA Male

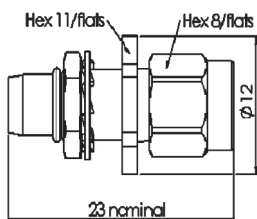

Part number	Interface	Panel drilling
R191 354 001	BMA Male - SMA Male	P03

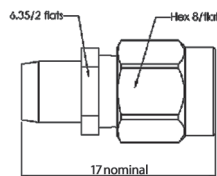

Part number	Interface
R191 350 001	BMA Male - SMA Male

To download data sheets and assembly instructions, visit [www.radiall.com](http://www.radiall.com) & enter the part number in the Search box.

**Bold part numbers** represent products typically in stock & available for immediate shipment.

See page 8 and 9 for packaging information.

STANDARD SERIES ADAPTERS

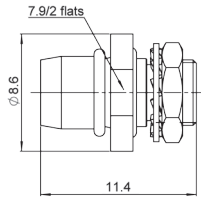

Part number	Interface	Panel drilling
R191 811 100	BMA Male - SMP Female	P13

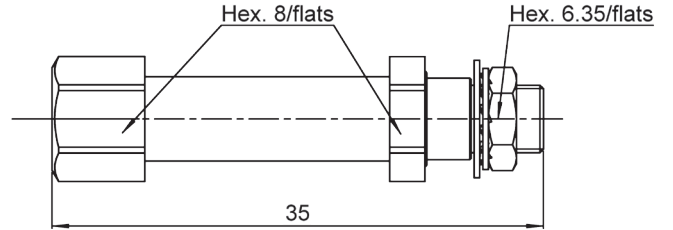

Part number	Interface
R191 815 100	BMA Female - SMP Male

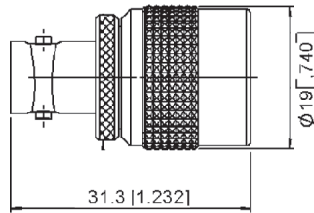

Part number	Interface
R191 429 000	BNC Female - C Male

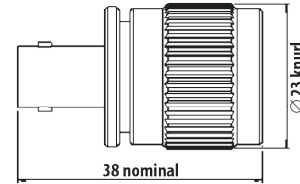

Part number	Interface
R191 449 000	BNC Female - HN Male

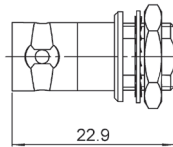

Part number	Interface	Panel drilling
R191 477 120	BNC Female - MCX Female	P10

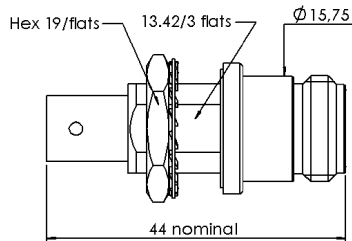

Part number	Interface	Panel drilling
R191 422 000	BNC Female - N Female	P11

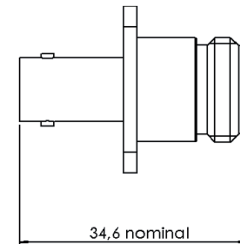

Part number	Interface	Panel drilling
R191 424 000	BNC Female - N Female	P01

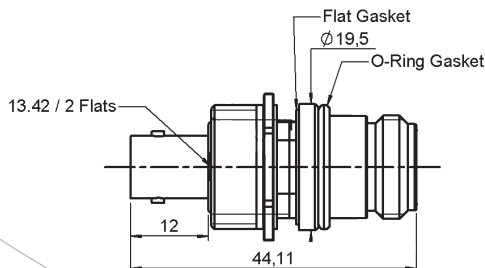

Part number	Interface	Panel drilling
R191 422 020	BNC Female - N Female	P11

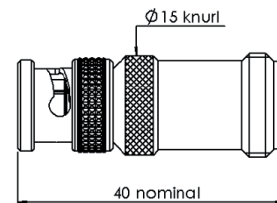

Part number	Interface
R191 419 000	BNC Male - N Female

# STANDARD SERIES ADAPTERS

ADAPTERS 50Ω

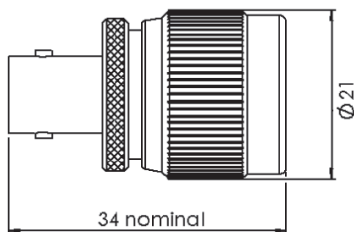

Part number	Interface
R191 421 000	BNC Female - N Male

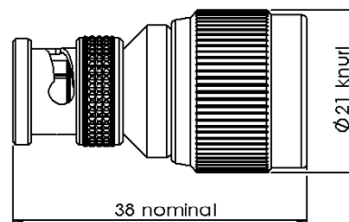

Part number	Interface
R191 417 000	BNC Male - N Male

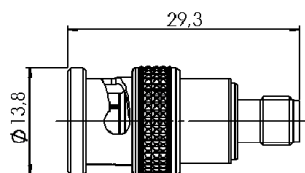

Part number	Interface
R191 305 000	BNC Male - SMA Female

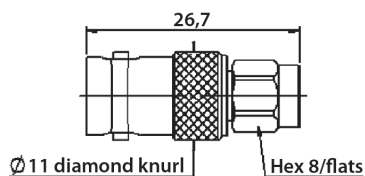

Part number	Interface
R191 303 000	BNC Female - SMA Male

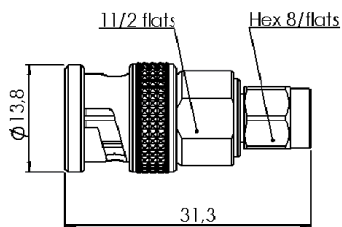

Part number	Interface
R191 301 000	BNC Male - SMA Male

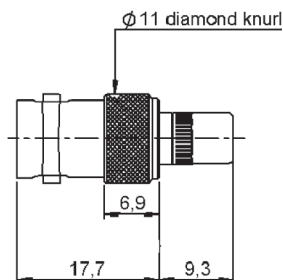

Part number	Interface
R191 215 000	BNC Female - SMB Female

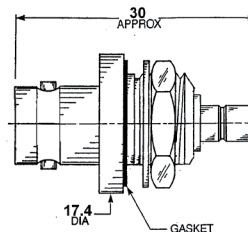

Part number	Interface	Panel drilling
5512-7501-000	BNC Female - SMB Male	P17

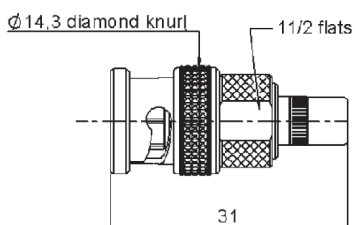

Part number	Interface
R191 214 000	BNC Male - SMB Female

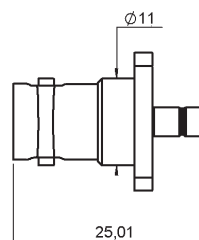

Part number	Interface	Panel drilling
R191 212 500	BNC Female - SMB Male	P14

To download data sheets and assembly instructions, visit [www.radiall.com](http://www.radiall.com) & enter the part number in the Search box.  
**Bold part numbers** represent products typically in stock & available for immediate shipment.  
 See page 8 and 9 for packaging information.

STANDARD SERIES ADAPTERS

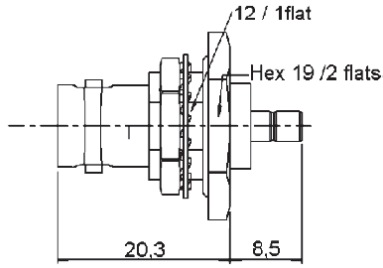

Part number	Interface	Panel drilling
R191 213 000	BNC Female - SMB Male	P04

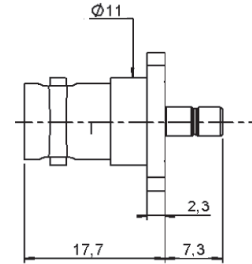

Part number	Interface	Panel drilling
R191 212 000	BNC Female - SMB Male	P02

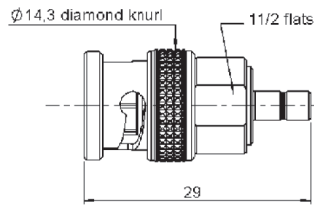

Part number	Interface
R191 209 000	BNC Male - SMB Male

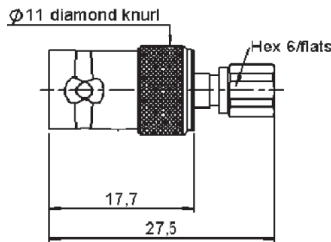

Part number	Interface
R191 123 000	BNC Female - SMC Female

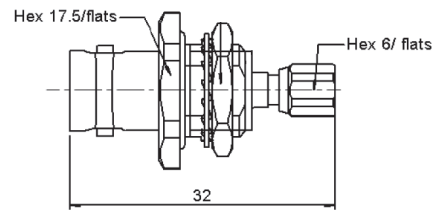

Part number	Interface	Panel drilling
R191 124 000	BNC Female - SMC Female	P06

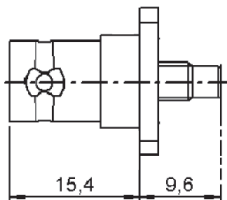

Part number	Interface	Panel drilling
R191 120 000	BNC Female - SMC Male	P02

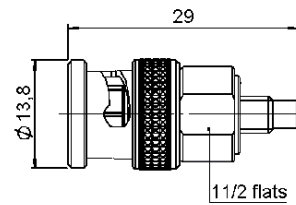

Part number	Interface
R191 117 000	BNC Male - SMC Male

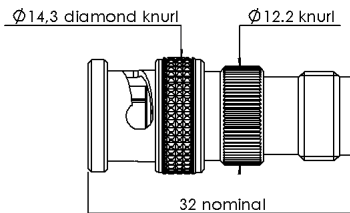

Part number	Interface
R191 403 000	BNC Male - TNC Female

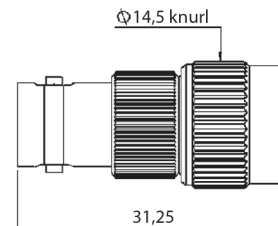

Part number	Interface
R191 405 000	BNC Female - TNC Male

# STANDARD SERIES ADAPTERS

ADAPTERS 50Ω

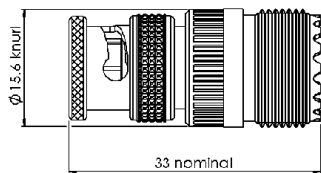

Part number	Interface
R191 445 000	BNC Male - UHF Female

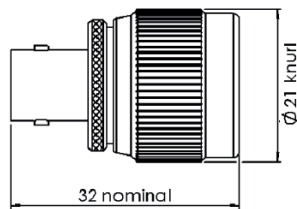

Part number	Interface
R191 447 000	BNC Female - UHF Male

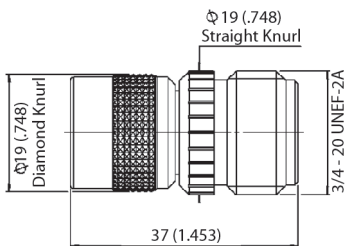

Part number	Interface
R191 933 000	C Male - HN Female

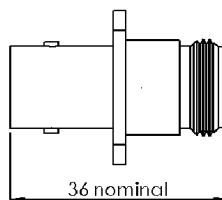

Part number	Interface	Panel drilling
R191 708 000	C Female - N Female	P01

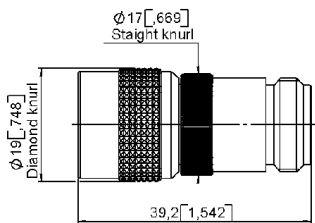

Part number	Interface
R191 705 000	C Male - N Female

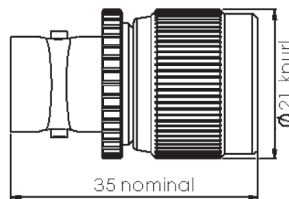

Part number	Interface
R191 703 000	C Female - N Male

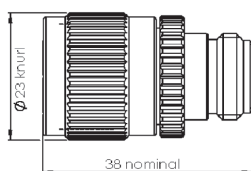

Part number	Interface
R191 737 000	HN Male - N Female

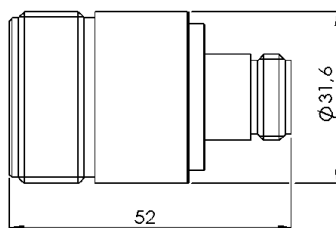

Part number	Interface
R191 741 000	LC Female - N Female

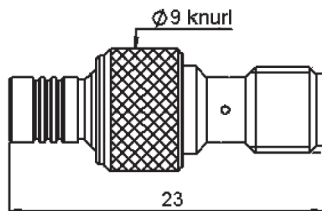

Part number	Interface
R191 388 000	MCX Female - SMA Female

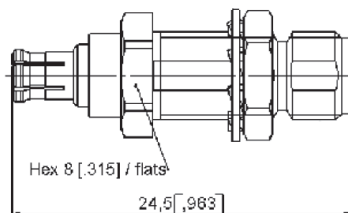

Part number	Interface	Panel drilling
R191 387 107	MCX Male - SMA Female	P07

To download data sheets and assembly instructions, visit [www.radiall.com](http://www.radiall.com) & enter the part number in the Search box.

**Bold part numbers** represent products typically in stock & available for immediate shipment.

See page 8 and 9 for packaging information.

# STANDARD SERIES ADAPTERS

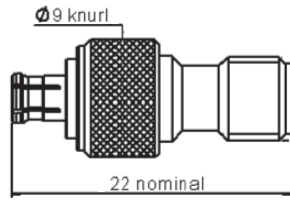

Part number	Interface
R191 387 000	MCX Male - SMA Female

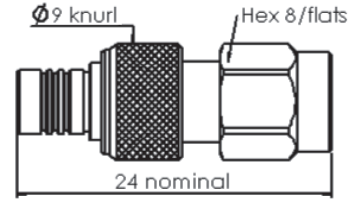

Part number	Interface
R191 386 000	MCX Female - SMA Male

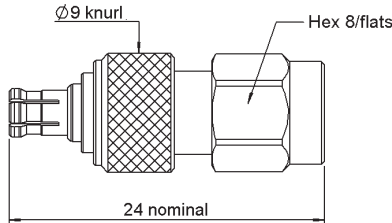

Part number	Interface
R191 385 000	MCX Male - SMA Male

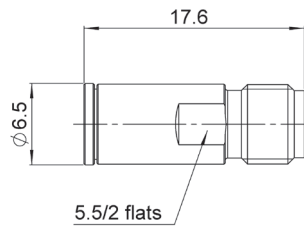

Part number	Interface
R191 389 400	MMBX Female - SMA Female

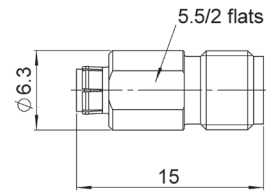

Part number	Interface
R191 389 200	MMBX Male - SMA Female

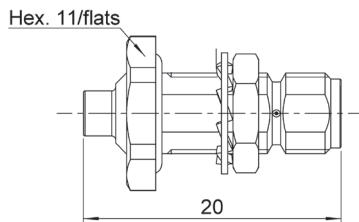

Part number	Interface	Panel drilling
R191 399 100	MMCX Female - SMA Female	P07

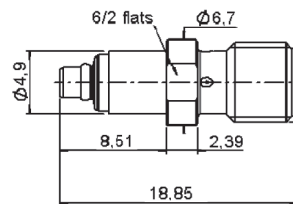

Part number	Interface
R191 398 020	MMCX Male - SMA Female

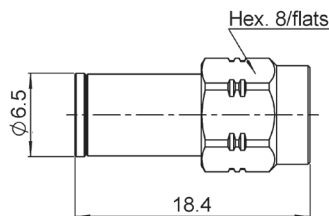

Part number	Interface
R191 389 300	MMCX Female - SMA Male

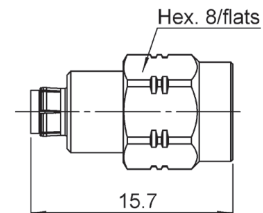

Part number	Interface
R191 389 100	MMCX Male - SMA Male

# STANDARD SERIES ADAPTERS

ADAPTERS 50Ω

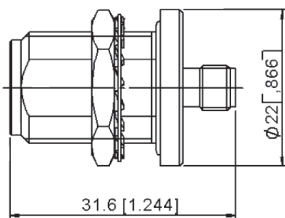

Waterproof

Part number	Interface	Panel drilling
<b>R191 334 000</b>	N Female - SMA Female	P05

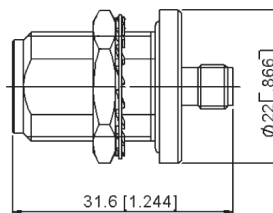

Part number	Interface	Panel drilling
<b>R191 332 000</b>	N Female - SMA Female	P05

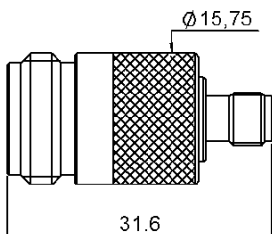

Part number	Interface
<b>R191 331 000</b>	N Female - SMA Female

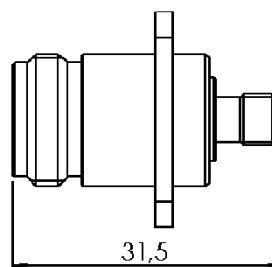

Part number	Interface	Panel drilling
<b>R191 381 000</b>	N Female - SMA Female	P01

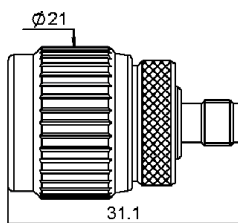

Part number	Interface
<b>R191 329 000</b>	N Male - SMA Female

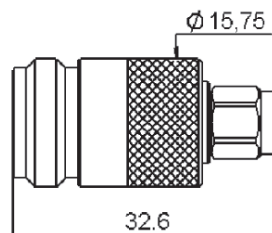

Part number	Interface
<b>R191 327 000</b>	N Female - SMA Male

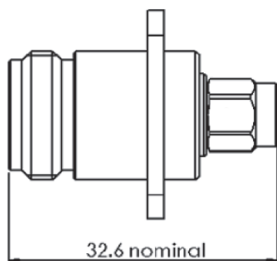

Part number	Interface	Panel drilling
<b>R191 377 000</b>	N Female - SMA Male	P01

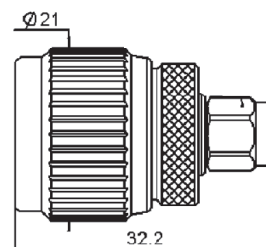

Part number	Interface
<b>R191 325 000</b>	N Male - SMA Male

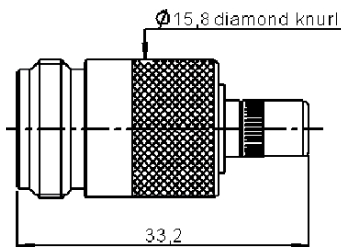

Part number	Interface
<b>R191 239 000</b>	N Female - SMB Female

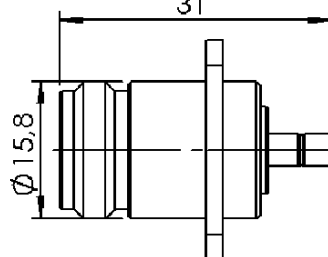

Part number	Interface	Panel drilling
<b>R191 236 000</b>	N Female - SMB Male	P01

To download data sheets and assembly instructions, visit [www.radiall.com](http://www.radiall.com) & enter the part number in the Search box.

**Bold part numbers** represent products typically in stock & available for immediate shipment.

See page 8 and 9 for packaging information.



STANDARD SERIES ADAPTERS

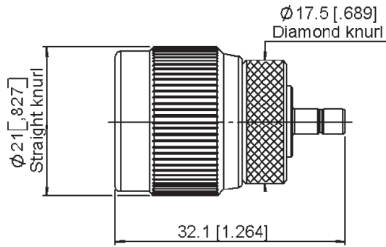

Part number	Interface
R191 233 000	N Male - SMB Male

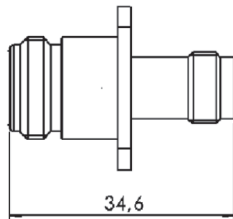

Part number	Interface	Panel drilling
R191 514 000	N Female - TNC Female	P01

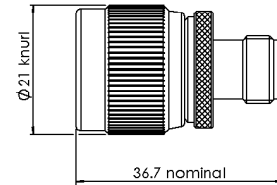

Part number	Interface
R191 513 000	N Male - TNC Female

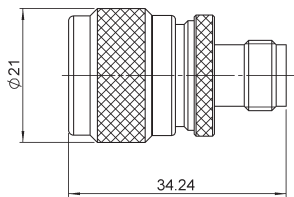

Part number	Interface
R191 513 050	N Male - TNC Female

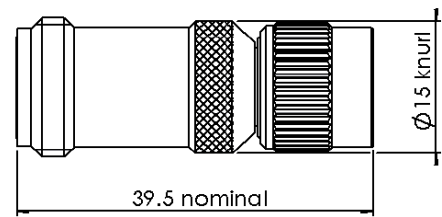

Part number	Interface
R191 511 000	N Female - TNC Male

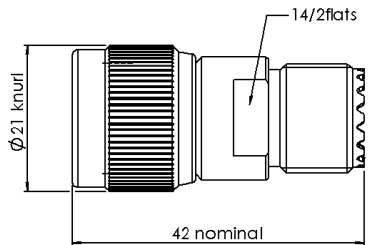

Part number	Interface
R191 731 000	N Male - UHF Female

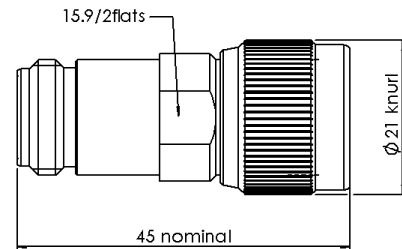

Part number	Interface
R191 733 000	N Female - UHF Male

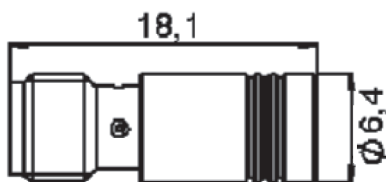

Part number	Interface
R191 203 007	SMA Female - SMB Female

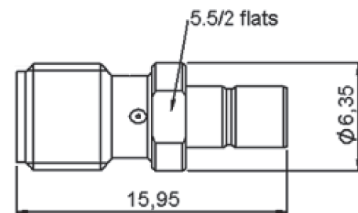

Part number	Interface
R191 201 007	SMA Female - SMB Male

# STANDARD SERIES ADAPTERS

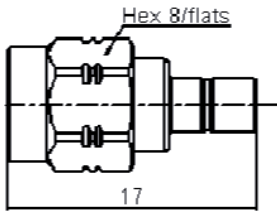

Part number	Interface
R191 200 007	SMA Male - SMB Male

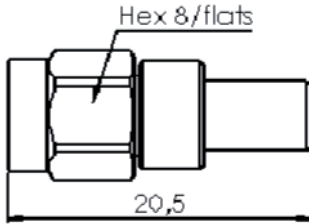

Part number	Interface
R191 374 000	SMA Male - SMC Female

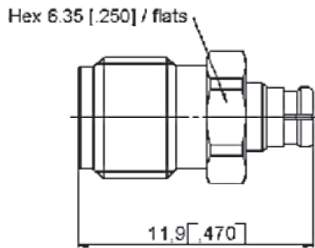

Part number	Interface
R191 844 002	SMA Female - SMP Female

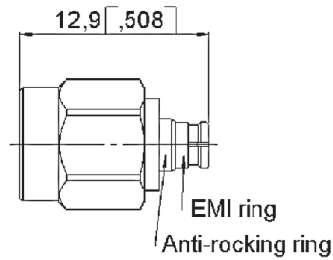

Part number	Interface
R191 842 002	SMA Male - SMP Female

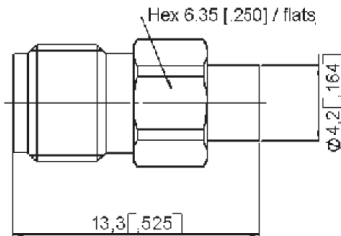

Part number	Interface
R191 843 001	SMA Female - SMP Male

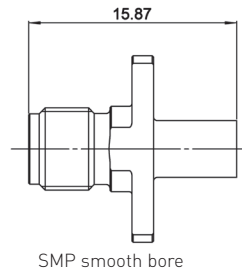

Part number	Interface	Panel drilling
R191 843 421	SMA Female - SMP Male	P15

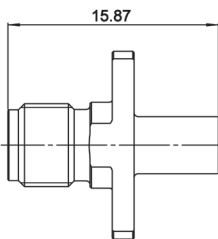

Part number	Interface	Panel drilling
R191 843 401	SMA Female - SMP Male	P15

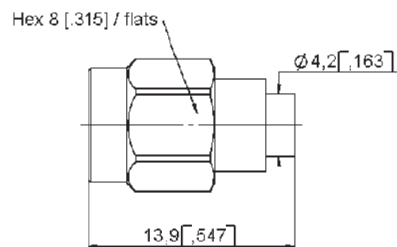

Part number	Interface
R191 841 001	SMA Male - SMP Male

To download data sheets and assembly instructions, visit [www.radiall.com](http://www.radiall.com) & enter the part number in the Search box.  
**Bold part numbers** represent products typically in stock & available for immediate shipment.  
 See page 8 and 9 for packaging information.