

ADAPTOR QRE 3.5 MALE

FEMALE SMA 3.5

R191.944.700

Série : ADAPT-MES

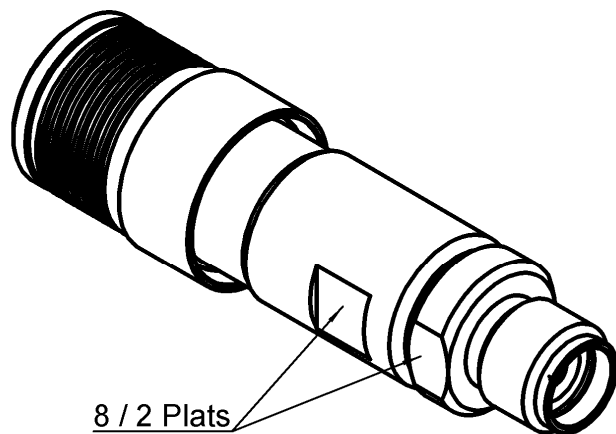
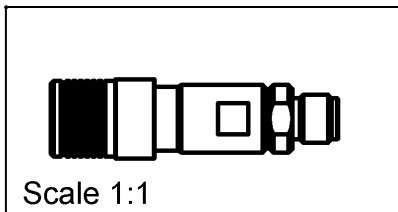
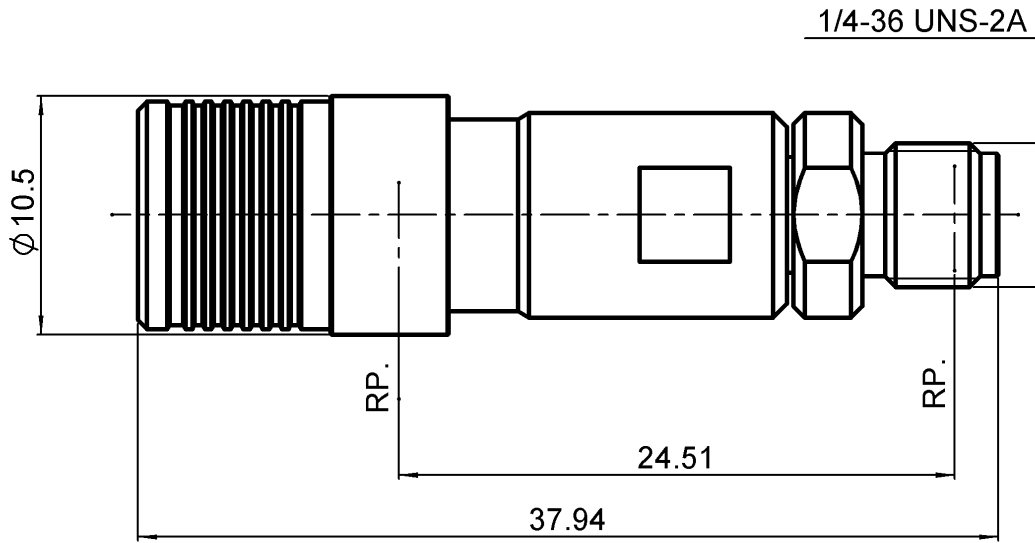

All dimensions are in mm.

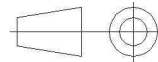

COMPONENTS	MATERIALS	PLATING (µm)
BODY	STAINLESS STEEL 316L + 303L	PASSIVATED
CENTER CONTACT	BERYLLIUM COPPER	GOLD 1.3 OVER NICKEL2
OUTER CONTACT	BERYLLIUM COPPER	NPGR
INSULATOR	Q200-5	
GASKET	FLUORO SILICON RUBBER	
OTHERS PARTS	STAINLESS STEEL (316L)	PASSIVATED
-	-	-
-	-	-

Issue : 0940 A

In the effort to improve our products, we reserve the rights to make changes judged to be necessary.



ADAPTOR QRE 3.5 MALE

R191.944.700

FEMALE SMA 3.5

Série : ADAPT-MES

PACKAGING

SPECIFICATION

Standard	Unit	Other
1	-	Contact us

ELECTRICAL CHARACTERISTICS

ENVIRONMENTAL

Impedance **50** Ω
 Frequency **0-12.4** GHz
 VSWR **1.07 + 0,0060** x F(GHz) Maxi
 Insertion loss **0.07** √F(GHz) dB Maxi
 RF leakage - (***** - F(GHz)) dB Maxi
 Voltage rating **500** Veff Maxi
 Dielectric withstanding voltage **1000** Veff mini
 Insulation resistance **5000** MΩ mini

Operating **-40/+80** °C
 Hermetic seal **NA** Atm.cm3/s
 Panel leakage **NA**

MECHANICAL CHARACTERISTICS

OTHER CHARACTERISTICS

Center contact retention
 Axial force – Mating end **27** N mini
 Axial force – Opposite end **27** N mini
 Torque **NA** N.cm mini

*RF leakage: 95 @ 3GHz / 80 @ 12.4 GHz

Recommended torque
 Mating **QRE 3.5** **NA** N.cm
 SMA3.5 **0** N.cm
 0 N.cm
 Panel nut N.cm

Mating life **100** Cycles mini
 Weight **13,1290** g

Issue : 0940 A

In the effort to improve our products, we reserve the rights to make changes judged to be necessary.



PRELIMINARY