

# Fakra PCB – Straight male with poka-yoke pin

Process: Reflow



R197.156.D38

TECHNICAL DATA SHEET

Rev	Date	Edited	Approved	Validated	Modification
1	22/08/2019	Y.Jamardo	Y.Gay	R.Chantre	Creation

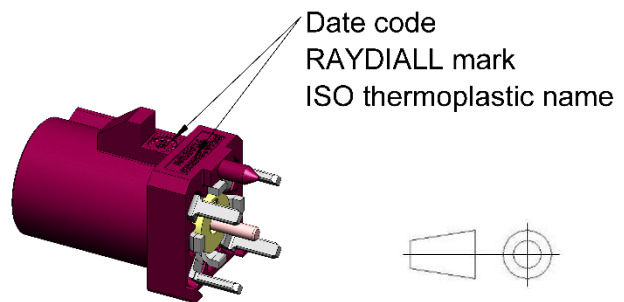
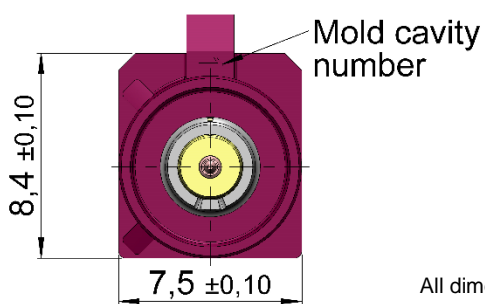
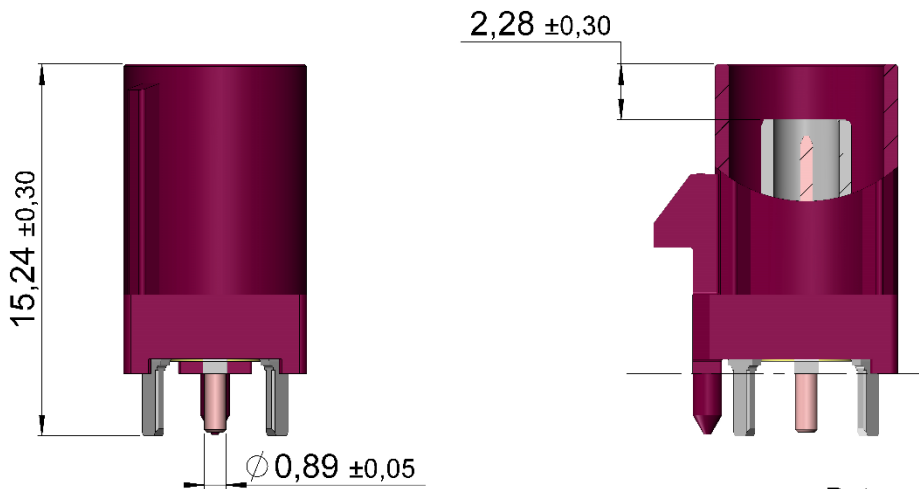
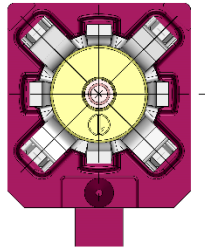

All dimensions are in mm

Components	Materials	Plating
Body	Brass	Matt Tin over Nickel
Center contact	Brass	Gold over Nickel
Insulator	High temperature polymer GF30	Natural color
Housing	High temperature polymer GF30	Bordeaux RAL 4004

**Interface** According to ISO 20860-1

**Application** TBD

### Electrical characteristics

Impedance	50 $\Omega$
Frequency	0-3 GHz
VSWR	$\leq 1.4$ (45MHz to 2GHz) $\leq 1.5$ (2GHz to 3GHz)
Voltage rating	335 Veff Maxi
Dielectric withstanding Voltage	1000 Veff maxi
Insulation resistance	$\geq 1000$ M $\Omega$

### Mechanical characteristics

Center contact retention, axial force, mating end	$\geq 10$ N mini
Center contact retention, axial force, opposite end	$\geq 10$ N mini
Housing retention	$\geq 110$ N mini
Mating cycles	$\geq 25$

### Environmental

Operating temperature	-40 / +105°C
RoHS compliant	

**Component weight** TBD

**Packaging**

5 plastic reels inside 1 cardboard box

**Primary packaging: plastic reel**

- Dimensions : Ø 380 x 38mm
- Number of connectors per reel: 350
- Carrier tape description:
  - 32mm width, 16mm pitch.
  - Material: thermoplastic static dissipative. Cover tape material: Thermoplastic antistatic

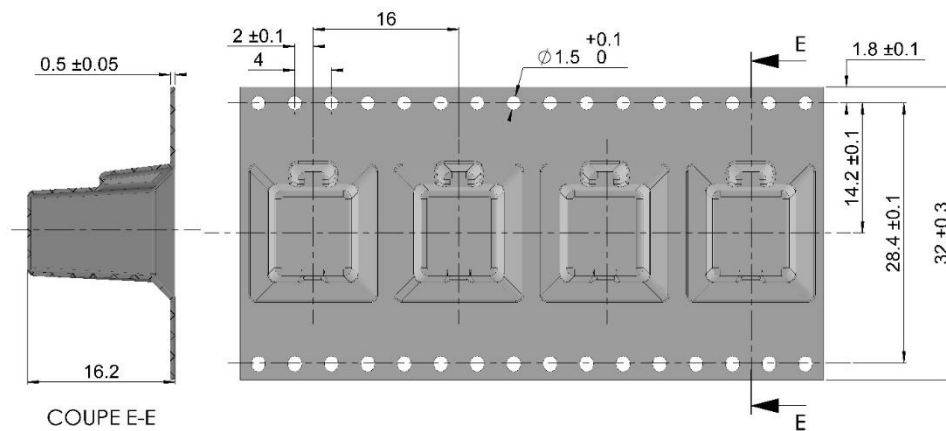
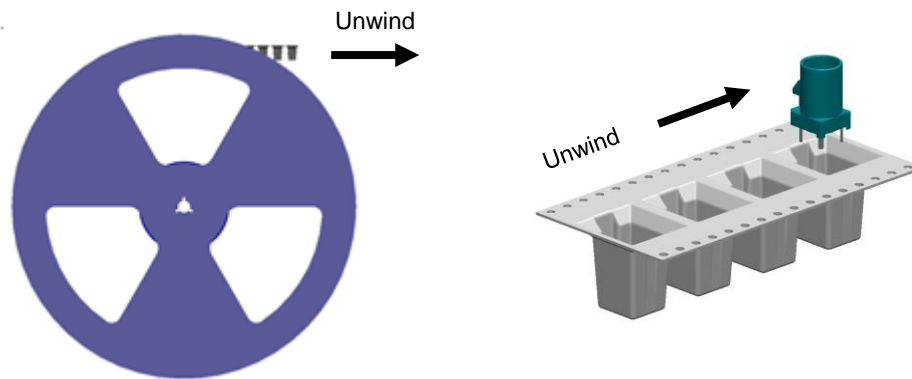

**Secondary packaging: Cardboard box**

- Outside dimensions: 40 x 40 x 20 cm
- Number of reels per cardboard box: 5
- Number of connectors per cardboard box: 1750
- Weight: 5.1 kg



