

THREAD-IN SHROUD 0.4MM

LIMITED DETENT

R222.550.301

Series : SMP

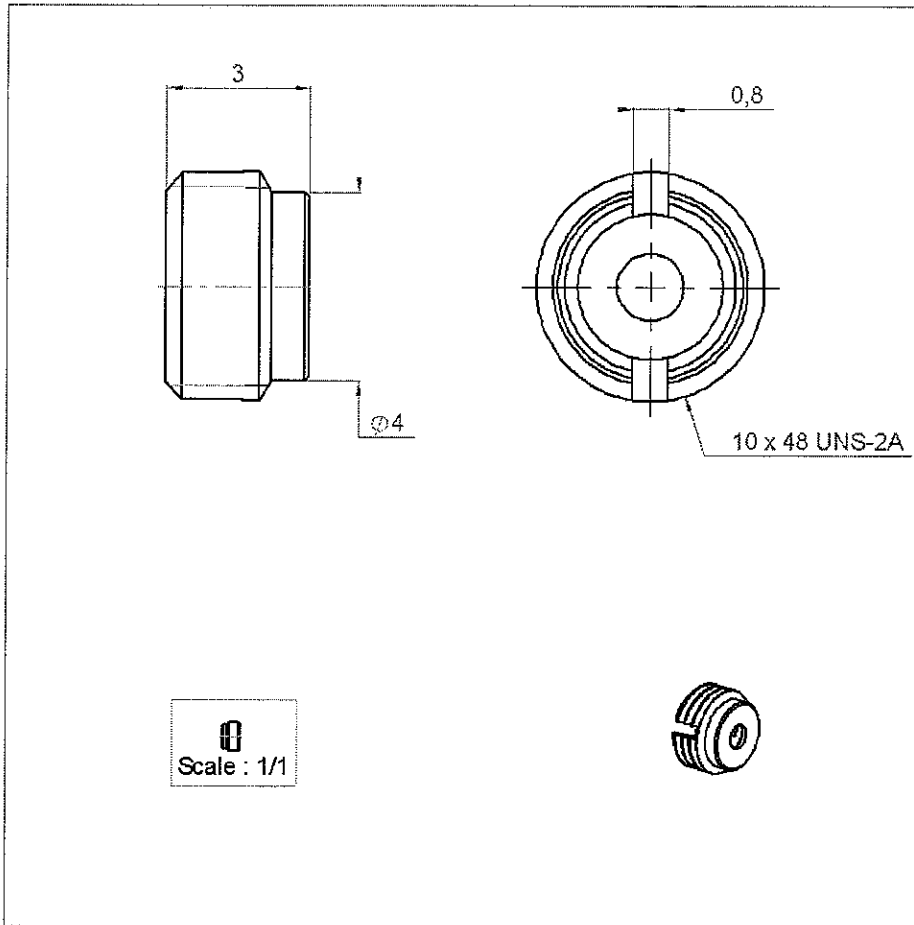

All dimensions are in mm.

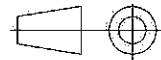

COMPONENTS	MATERIALS	PLATINGS (μm)
BODY	STAINLESS STEEL	PASSIVATED .
CENTER CONTACT	-	-
OUTER CONTACT	-	-
INSULATOR	-	-
GASKET	-	-
OTHERS PARTS	-	-
-	-	-
-	-	-

Issue : 0529 B

In the effort to improve our products, we reserve the right to make changes judged to be necessary.



THREAD-IN SHROUD 0.4MM

R222.550.301

LIMITED DETENT

Series : SMP

PACKAGING

SPECIFICATION

Standard	Unit	Other
100	'W' option	Contact us

ELECTRICAL CHARACTERISTICS

ENVIRONMENTAL

Impedance NA Ω
 Frequency NA GHz
 VSWR NA + 0,0000 x F(GHz) Maxi
 Insertion loss NA √F(GHz) dB Maxi
 RF leakage -(NA - F(GHz)) dB Maxi
 Voltage rating NA Veff Maxi
 Dielectric withstanding voltage NA Veff mini
 Insulation resistance NA MΩ mini

Operating temperature -65/+165 ° C
 Hermetic seal NA Atm.cm3/s
 Panel leakage NA

OTHERS CHARACTERISTICS

Assembly instruction

Others :
 -

MECHANICAL CHARACTERISTICS

Center contact retention
 Axial force – Mating end NA N mini
 Axial force – Opposite end NA N mini
 Torque NA N.cm mini

Recommended torque
 Mating NA N.cm
 Panel nut 90 N.cm

Mating life 500 Cycles mini
 Weight 0,1400 g

Issue : 0529 B

In the effort to improve our products, we reserve the right to make changes judged to be necessary.

