

PAGE 1/3	ISSUE 09-01-15B	SERIES SMP	PART NUMBER R222561701
----------	-----------------	------------	------------------------

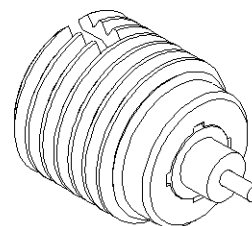

All dimensions are in mm.

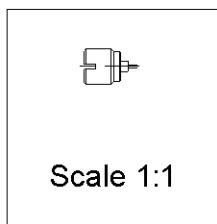
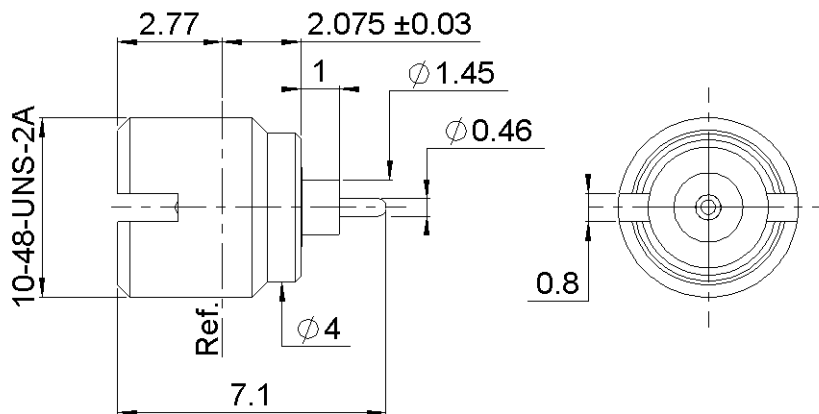
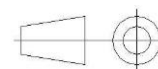

COMPONENTS	MATERIALS	PLATING (µm)
Body	STAINLESS STEEL	PASSIVATED.
Center contact	BERYLLIUM COPPER	GOLD OVER NICKEL
Outer contact	-	-
Insulator	PTFE	-
Gasket	-	-
Others parts	-	-
-	-	-
-	-	-

PAGE 2/3	ISSUE 09-01-15B	SERIES SMP	PART NUMBER R222561701
----------	------------------------	-------------------	-------------------------------

PACKAGING

Standard	Unit	Other
100	Contact us	Contact us

ELECTRICAL CHARACTERISTICS

Impedance		50	Ω	
Frequency		0-40	GHz	
VSWR	1.3* +	0,0000	x F(GHz) Maxi	
Insertion loss		0.12	√F(GHz) dB Maxi	
RF leakage	- (NA	- F(GHz)) dB Maxi	
Voltage rating		335	Veff Maxi	
Dielectric withstanding voltage		500	Veff mini	
Insulation resistance		5000	MΩ mini	

MECHANICAL CHARACTERISTICS

Center contact retention				
Axial force – Mating End		6.8	N mini	
Axial force – Opposite end		6.8	N mini	
Torque		NA	N.cm mini	
Recommended torque				
Mating		NA	N.cm	
Panel nut		90	N.cm	
Mating life		1000	Cycles mini	
Weight		0,3990	g	

ENVIRONMENTAL

Operating temperature	-65/+165	°C
Hermetic seal		Atm.cm3/s
Panel leakage	NA	

SPECIFICATION

OTHER CHARACTERISTICS

Assembly instruction:

Others:

***Coaxial transmission line**