

PAGE 1/4	ISSUE 26-04-18A	SERIES <b>DIVERS</b>	PART NUMBER <b>R299763000</b>
----------	-----------------	----------------------	-------------------------------

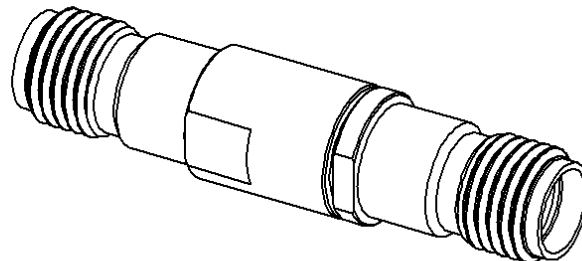

All dimensions are in mm. Tolerances according ISO 2768 m-H

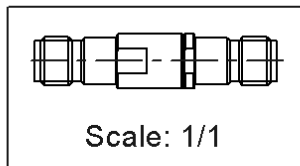
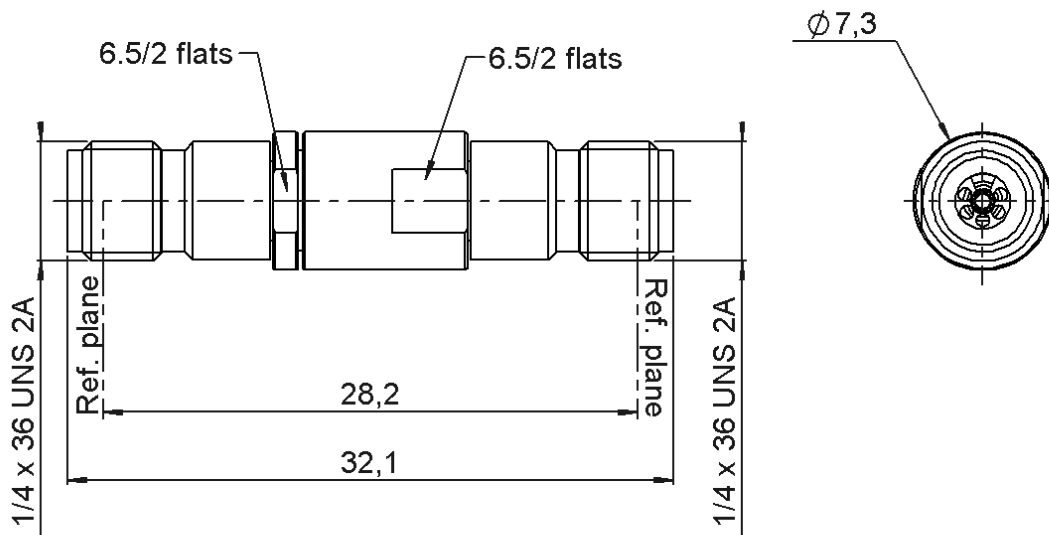
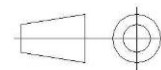

COMPONENTS	MATERIALS	PLATING ( $\mu\text{m}$ )
Body	<b>STAINLESS STEEL, BRASS</b>	<b>GOLD OVER NICKEL</b>
Center contact	<b>BERYLLIUM COPPER</b>	<b>GOLD OVER NICKEL</b>
Outer contact		
Insulator	<b>PEEK</b>	
Gasket		
Others parts		
-	-	-
-	-	-

PAGE 2/4	ISSUE <b>26-04-18A</b>	SERIES <b>DIVERS</b>	<b>PART NUMBER R299763000</b>
----------	------------------------	----------------------	-------------------------------

**PACKAGING**

Standard	Unit	Other
<b>1</b>	<b>Contact us</b>	<b>Contact us</b>

**ELECTRICAL CHARACTERISTICS**

Impedance		<b>50</b>	Ω
Frequency		<b>0-18</b>	GHz
VSWR	* +	<b>0,0000</b>	x F(GHz) Maxi
Insertion loss		<b>**</b>	√F(GHz) dB Maxi
RF leakage	- (	<b>NA</b>	- F(GHz) dB Maxi
Voltage rating		<b>90</b>	Veff Maxi
Dielectric withstanding voltage		<b>130</b>	Veff mini
Insulation resistance		<b>5000</b>	MΩ mini

**MECHANICAL CHARACTERISTICS**

Center contact retention			
Axial force – Mating End		<b>27</b>	N mini
Axial force – Opposite end		<b>27</b>	N mini
Torque		<b>NA</b>	N.cm mini
Recommended torque			
Mating		<b>NA</b>	N.cm
Panel nut		<b>NA</b>	N.cm
Mating life		<b>500</b>	Cycles mini
Weight		<b>6,0000</b>	g

**ENVIRONMENTAL**

Operating temperature	<b>-65/+165</b>	°C
Hermetic seal	<b>NA</b>	Atm.cm3/s
Panel leakage	<b>NA</b>	

**SPECIFICATION**

**OTHER CHARACTERISTICS**

Assembly instruction:

Others:

- \***V.S.W.R: 1.3 max DC-12GHz**
- \***V.S.W.R: 1.5 max 12.5-18GHz**
- \*\***0.13 dB max**

PAGE 3/4	ISSUE 26-04-18A	SERIES <b>DIVERS</b>	<b>PART NUMBER R299763000</b>
----------	-----------------	----------------------	-------------------------------

**COMPONENTS**

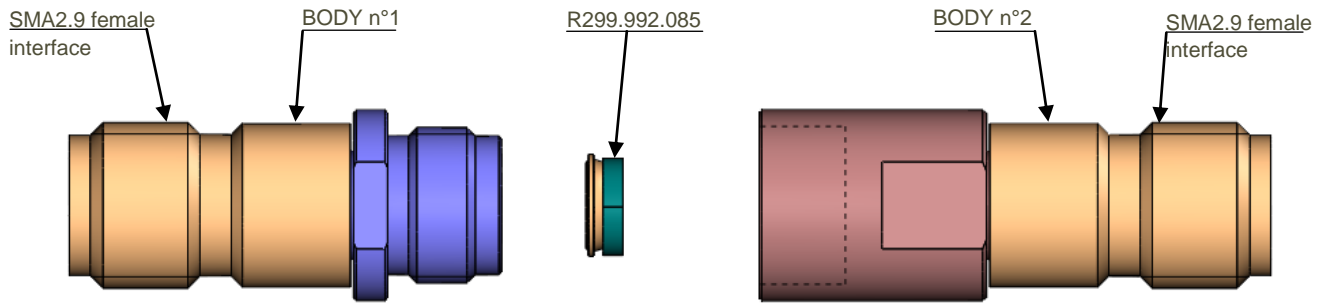

**1**

- Hold the body 1 of the measuring connector.
- Take the R299.992.085 connector to measure in V.S.W.R.
- Mount the R229.992.085 connector in the body cavity 1.

**-Warning**  
Observe the mounting direction.

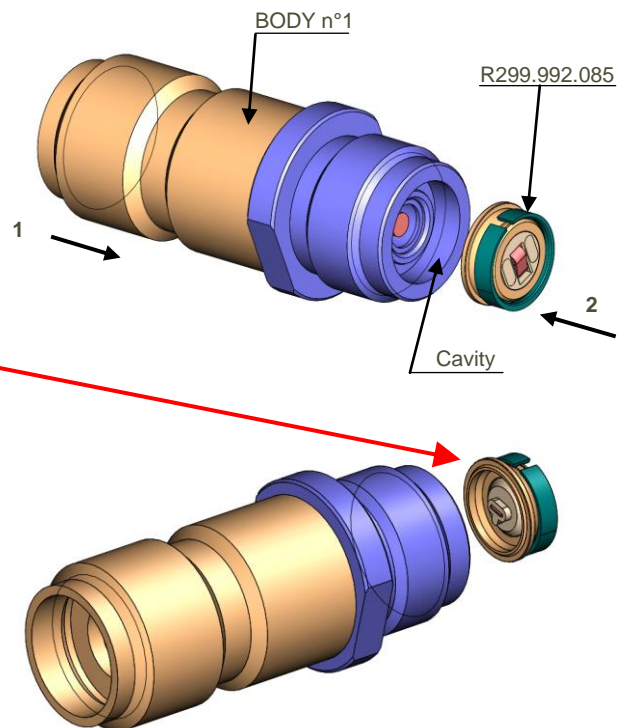

**2**

- Take the body 2 of the measuring connector.
- Screw the body 2 onto the body 1 of the measuring connector.
- Recommended tightening torque: 90N.cm**

