

PAGE 1/1	ISSUE 10-04-15A	SERIES MML	PART NUMBER <b>R302000000 XXX</b>
----------	-----------------	------------	-----------------------------------

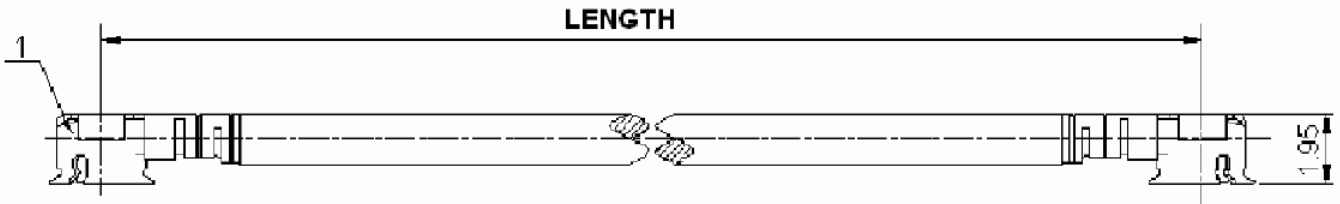

Length=XXX	Step	Tolerance
30 to 100	10	±2
110 to 200		±3
225 to 300	25	±5
325 to 500		±10

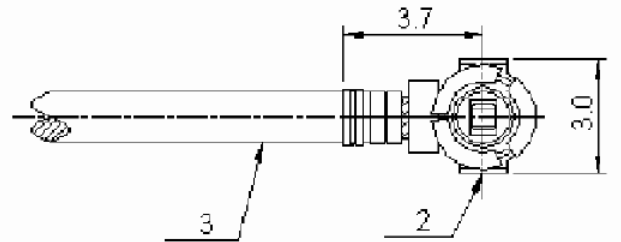

E.g. XXX=070 means length is 70±2, the part number is R302.000.000 070

All dimensions are in mm.

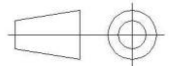

- \* 1 \* Connector A : **MML H2.5 PLUG (gold plated)**
- \* 2 \* Connector B : **MML H2.5 PLUG (gold plated)**
- \* 3 \* Cable **1.37/50S BLACK**  
Type

### ELECTRICAL CHARACTERISTICS

Impedance		<b>50</b>	Ω
Frequency		<b>0-6</b>	GHz
Operating temperature		<b>-40/+90</b>	° C
VSWR	<b>1.3**</b>	<b>+</b>	<b>0.000</b> x F(GHz) Maxi
Insertion loss		<b>0.63*</b>	√F(GHz) dB Maxi
Voltage rating		<b>250</b>	Veff Maxi
Dielectric withstanding voltage		<b>300</b>	Veff mini
Insulation resistance		<b>500</b>	MΩ mini

### SPECIFICATION

Weight	<b>0.800*</b>	g
Cable retention	<b>4</b>	N mini
Mating life	<b>30</b>	Cycles

Others  
**\*\*VSWR up to 3GHz 1.3 max**  
**Up to 6GHz 1.5 max**

Length	*Insertion loss(Maxi)	*Weight(Maxi)
30 to 100	0.73 dB	3.00 g
110 to 200	1.16 dB	3.5 g
225 to 400	2.02 dB	4.10 g

### Mating status

