

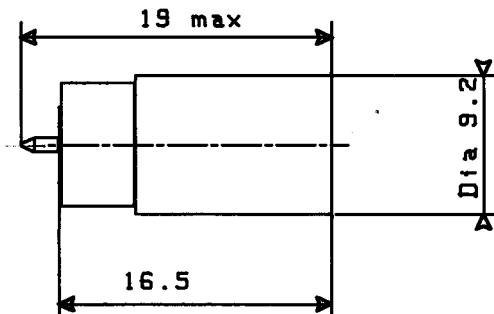

TITLE **REMOVABLE CARTRIDGE**

LTR. **A**

DRAWING:



Mounted in a detector case type R 451576.

General tolerances : ± 0.5 mm

ELECTRICAL CHARACTERISTICS:

- FREQUENCY RANGE : .01 - 18 GHz
- IMPEDANCE : 50 Ohms
- POLARITY : Negative
- FREQUENCY RESPONSE:
 - (0.01 - 8 GHz) : ± 0.2 dB/Octave
 - (0.01 - 12.4 GHz) : ± 0.5 dB
 - (0.01 - 18 GHz) : ± 1 dB
- V.S.W.R. :
 - (0.01 - 8 GHz) : ≤ 1.35
 - (8 - 18 GHz) : ≤ 1.50
- SENSITIVITY:
 - LOW LEVEL (Input power ≤ -20 dbm): > 500 mV/mW
 - HIGH LEVEL (Input power $= 0.35$ mW): > 100 mV
- TANGENTIAL SENSITIVITY : - 44 dB mini
- SQUARE LAW RESPONSE LIMIT : - 12 dBm
- VIDEO IMPEDANCE : 1 k Ω Typical
- VIDEO CAPACITY : 20 pF Typical
- AVERAGE POWER (CW) : 200 mW Maxi
- SCHOTTKY DIODE : <<Zero bias>>

Tentative data subject to change without notice.

3294 - 8902

PEN CART	QUALITY Dept. App. MO				
	A	16 JAN. 1990			
PAGE 1/1	DATE 16/01/90	NAME K. LUCIEN	LTR	REVISIONS	DATE APP.



TITLE **REMOVABLE CARTRIDGE**

LTR. **A**

DRAWING:

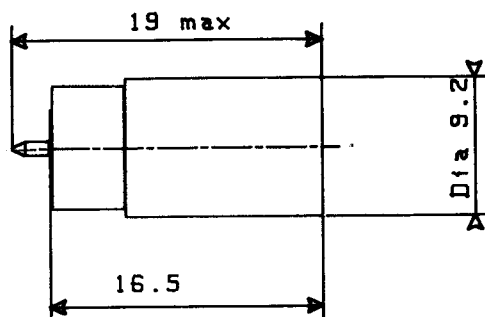

Mounted in a detector case type R 451576.

General tolerances : ± 0.5 mm

ELECTRICAL CHARACTERISTICS:

FREQUENCY RANGE : .01 - 18 GHz
 IMPEDANCE : 50 Ohms
 POLARITY : Negative
 FREQUENCY RESPONSE:
 (0.01 - 8 GHz) : ± 0.2 dB/Octave
 (0.01 - 12.4 GHz) : ± 0.5 dB
 (0.01 - 18 GHz) : ± 1 dB
 V.S.W.R. :
 (0.01 - 8 GHz) : ≤ 1.35
 (8 - 18 GHz) : ≤ 1.50
 SENSITIVITY:
 LOW LEVEL (Input power ≤ -20 dbm): > 500 mV/mW
 HIGH LEVEL (Input power $= 0.35$ mW): > 100 mV
 TANGENTIAL SENSITIVITY : - 44 dB mini
 SQUARE LAW RESPONSE LIMIT : - 12 dBm
 VIDEO IMPEDANCE : 1 k Ω Typical
 VIDEO CAPACITY : 20 pF Typical
 AVERAGE POWER (CW) : 200 mW Maxi
 SCHOTTKY DIODE : $\langle\langle$ Zero bias $\rangle\rangle$

Tentative data subject to change without notice. 3294 - 8902

PEN CAT	QUALITY Dpt App. MO	DATE 16/01/90	NAME K. LUCIEN	LTR	REVISIONS	DATE	APP.
	A						