



RADIALL

R451953000

**TECHNICAL
DATA SHEET**

TITLE REMOVABLE CARTRIDGE

LTR. A

DRAWING:

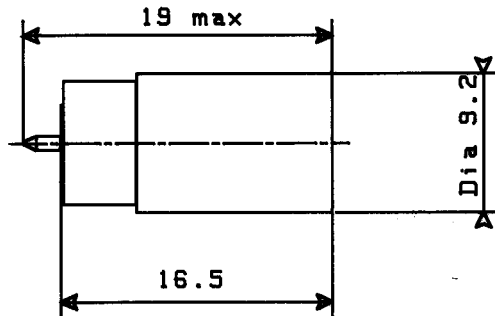

Mounted in a detector case type R 451576500.

General tolerances : ± 0.5 mm

ELECTRICAL CHARACTERISTICS:

- FREQUENCY RANGE : .01 - 18 GHz
- IMPEDANCE : 50 Ohms
- POLARITY : Positive
- FREQUENCY RESPONSE:
 - (0.01 - 8 GHz) : ± 0.2 dB/Octave
 - (0.01 - 12.4 GHz) : ± 0.5 dB
 - (0.01 - 18 GHz) : ± 1 dB
- V.S.W.R. :
 - (0.01 - 8 GHz) : ≤ 1.35
 - (8 - 18 GHz) : ≤ 1.50
- SENSITIVITY:
 - LOW LEVEL (Input power ≤ -20 dbm): > 500 mV/mW
 - HIGH LEVEL (Input power $= 0.35$ mW): > 100 mV
- TANGENTIAL SENSITIVITY : - 44 dB mini
- SQUARE LAW RESPONSE LIMIT : - 12 dBm
- VIDEO IMPEDANCE : 1 k Ω Typical
- VIDEO CAPACITY : 20 pF Typical
- AVERAGE POWER (CW) : 200 mW Maxi
- SCHOTTKY DIODE : <<Zero bias>>

Tentative data subject to change without notice.

PEN CAT	QUALITY Dpt App.					
	MO B	13 MAY 1992				
PAGE 1/1	DATE 11/05/92	NAME K.LUCIEN	LTR	REVISIONS	DATE	APP.