

PHASE SHIFTER SMA M - SEMI RIDID .141

DC - 18 GHZ

R499.101.000

Series : **PHASE SHIFTER**

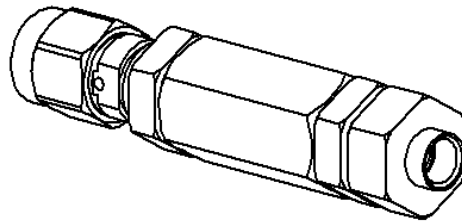
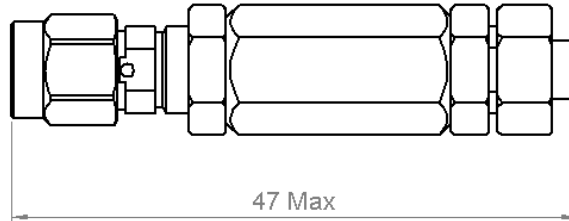

dimensions are in mm.

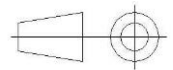

pn

ao

Weight 19,3700 g

Issue : 15-07-19A A

In the effort to improve our products, we reserve the right to make changes judged to be necessary.



PHASE SHIFTER SMA M - SEMI RIGID .141**DC - 18 GHZ****R499.101.000**Series : **PHASE
SHIFTER****RF CHARACTERISTICS**

| | |
|--------------------------------|---------------------------------------|
| FREQUENCY RANGE | : DC – 18 GHz |
| IMPEDANCE | : 50 Ohms |
| INSERTION LOSS | : $\leq 0.1 \times \sqrt{F}$ (GHz) dB |
| V.S.W.R | : $\leq 1.05 + 0.014 \times F$ (GHz) |
| PHASE SHIFT RANGE | : $10^\circ \times F$ (GHz) |
| PHASE SHIFT RANGE PER ROTATION | : $0.6^\circ \times F$ (GHz) |
| MAX AVERAGE POWER | : 200W at 500 MHz |
| MAX AVERAGE POWER | : 40W at 18 GHz |

MECHANICAL CHARACTERISTICS

| | |
|---------------------------|----------------------------|
| CONNECTOR | : SMA male per MIL-C 39012 |
| WEIGHT | : < 20 g |
| MAXIMUM LENGTH VARIATION | : 8.6 mm |
| SEMI RIGID CABLE ASSEMBLY | : By soldering |

ENVIRONMENTAL CHARACTERISTICS

| | |
|-----------------------------|----------------|
| OPERATING TEMPERATURE RANGE | : -55 / +125°C |
| STORAGE TEMPERATURE RANGE | : -55 / +125°C |

Issue : 15-07-19A A

In the effort to improve our products, we reserve the right to make changes judged to be necessary.

