

UNCONTROLLED DOCUMENT

PART NUMBER
SSF-LXHM250XXX

REV.

REV. E.C.N. NUMBER AND REVISION COMMENTS

DATE

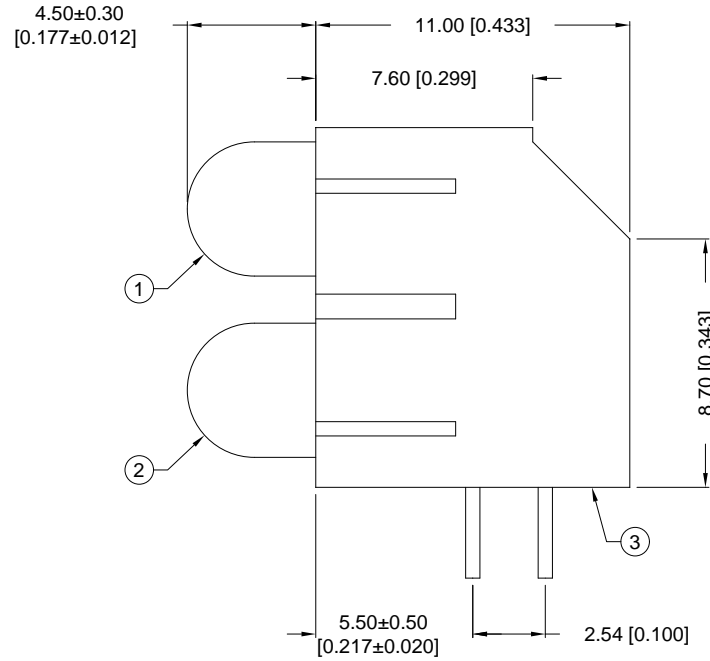
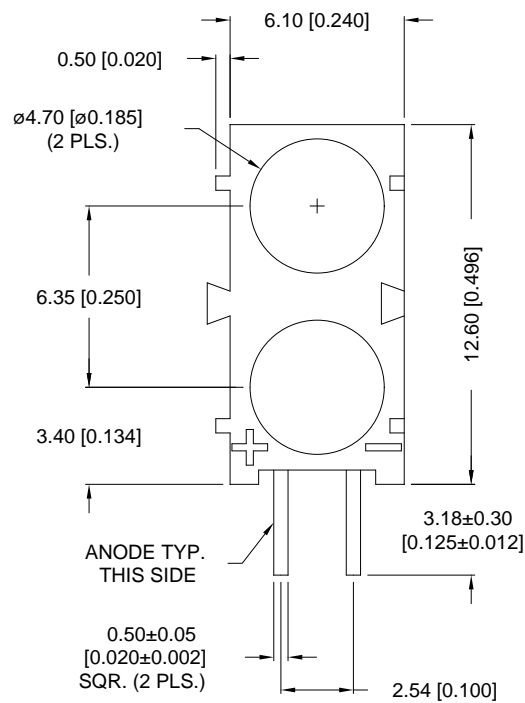

NOTES:

1. SSL-LX509F3XD, LED.
2. SSL-LX509F3XD, LED.
3. SSH-LXHM250, BLACK HOLDER.

UNCONTROLLED DOCUMENT

*UNLESS OTHERWISE SPECIFIED TOLERANCE IS ±0.25mm (±0.010")

REV.	PART NUMBER SSF-LXHM250XXX	<p>CONFIDENTIAL INFORMATION</p> <p>THE INFORMATION CONTAINED IN THIS DOCUMENT IS THE PROPERTY OF LUMEX INC. EXCEPT AS SPECIFICALLY AUTHORIZED IN WRITING BY LUMEX INC., THE HOLDER OF THIS DOCUMENT SHALL KEEP ALL INFORMATION CONTAINED HEREIN CONFIDENTIAL AND SHALL PROTECT SAME IN WHOLE OR IN PART FROM DISCLOSURE AND DISSEMINATION TO ALL THIRD PARTIES.</p> <p>RELIABILITY NOTE</p> <p>OUR MANY YEARS OF EXPERIENCE DATA ACCUMULATION INDICATE THAT SOLDER HEAT IS A MAJOR CAUSE OF EARLY AND FUTURE FAILURE. PLEASE PAY ATTENTION TO YOUR SOLDERING PROCESS.</p>	<p>LUMEX INCORPORATED</p> <p>290 E. HELLEN ROAD PALATINE, ILLINOIS 60067 PHONE: 1-847-359-2790 WEB: HTTP://WWW.LUMEX.COM</p>
	T-5mm (T-1 3/4) LED, RIGHT ANGLE FAULT INDICATOR, FIRST 'X';TOP LED COLOR, SECOND 'X';BOTTOM LED COLOR, THIRD 'X';DIFFUSION OF LENS.	<p>DRAWN BY: BC</p>	<p>CHECKED BY:</p> <p>APPROVED BY:</p> <p>DATE: 7-7-93 PAGE: 1 OF 1 SCALE: N/A</p>

PC LED Dual Mating Holder

INDEX

PRODUCT TREE

- [Product Table](#)
- [Applications](#)
- [Features](#)
- [Material Specifications](#)
- [Order Samples](#)
- [Stock/Price Request](#)
- [Sales and Tech Support](#)

1. [Product Gallery](#)
2. [LED Panel, PCB and Array Indicator Assemblies](#)
3. [PCB LED Indicators](#)
4. [PCB LEDs T-5mm \(T-1 3/4\)](#)
5. [P.C.B. LEDs - Dual/Tower](#)
6. [PC LED Dual Mating Holder](#)

[View](#) Image next to part no. indicates cad file.

Lumex drawings are in PDF format. If you don't have Adobe Acrobat, click on this icon to

[download a free copy](#)

Lumex Part Nbr	Emitted Color	Peak (nm)	Operating Current (mA)	Operating Typical Volts (V)	Brightness Typical (mCD)	If (mA)	Led Series Used
SSF-LXHM250GGD View	Green <input type="checkbox"/>	565	10-25	2.1	14	20	SSL-LX509F3XX
SSF-LXHM250IGIGW View	Red/Green <input type="checkbox"/>	635/565	10-25	2.1	8/8	20	SSL-LX509F3IGW
SSF-LXHM250IID View	Red <input type="checkbox"/>	635	10-25	2.1	15	20	SSL-LX509F3XX
SSF-LXHM250LGGD View	Green <input type="checkbox"/>	565	1-5	1.8	1.5	2	SSL-LX509F3LXX
SSF-LXHM250LIID View	Red <input type="checkbox"/>	635	1-5	1.8	1.5	2	SSL-LX509F3LXX
SSF-LXHM250LYYD View	Yellow <input type="checkbox"/>	585	1-5	1.8	1.5	2	SSL-LX509F3LXX
SSF-LXHM250SRSRD View	Red <input type="checkbox"/>	660	10-25	1.7	70	20	SSL-LX509F3XX
SSF-LXHM250YYD View	Yellow <input type="checkbox"/>	585	10-25	2.1	14	20	SSL-LX509F3XX