

WL50-3 LED Work Light

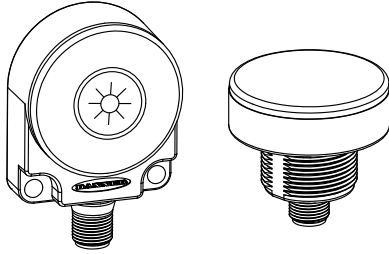

Datasheet

General Purpose LED Work Lights



Shown are flat-mount model with touch-button and 30 mm base-mount model without the touch-button

- Designed for desk, work station, enclosure, and small area lighting
- Optimized for use with flex arm mount for adjustable, industrial task lighting ¹
- Excellent, even distribution for close range lighting applications
- Standard or touch models available
- Touch models can be actuated with bare hands or gloves via the integrated capacitive switch on the face of the model
- Flat-mount or 30 mm base-mount models available
- Cabled, quick-disconnect, and terminal connection models available
- Rugged, sealed polycarbonate housing rated to IEC IP65, IEC IP67, and IP69K
- Low-profile design with several mounting options
- 12 V DC to 30 V DC operation
- High lumen output and low power consumption at less than 3 watts
- Touch models are dimmable via the touch interface, and all models are dimmable via PWM ² input on the control wire

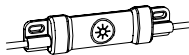



For PWM dimming, use with the LC15T-127AP1RBGQP dimmer module. For more information, refer to the LC15T In-Line Touch Switch datasheet, p/n 217460.

Models

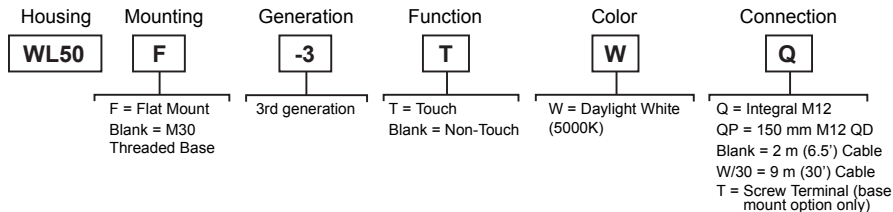
Flat mount models include a 48 mm (1.9 in) circular velcro mounting kit for easy mounting with no additional hardware.



Device Configuration

Device Interface	Function
 Single Touch	<p>ON/OFF</p> <p>A single touch in the off-state turns the device on. A single touch in the on-state turns the device off.</p>
 Touch and Hold	<p>Lumen Control</p> <p>Touch and hold to increase the Lumen Output from 10% to 100%. Continue to touch and hold to decrease the Lumen Output from 100% to 10%.</p>
 Double Touch	<p>100% ON</p> <p>Double touch to return to 100% Lumen Output.</p>



Note: The unit flashes at the maximum and the minimum state to notify user that the limit has been reached.

¹ Flex Arm Lights are available pre-assembled with integrated WL50 light for plug and play operation with available power supplies. Refer to the Flex Arm Light literature, p/n 222095, and PSW-24-1 Power Supply literature, p/n 214507.

² Pulse width modulation is a digital way to represent an analog value by varying the width of pulses at a constant frequency. The duty cycle (on-time versus off-time) is measured in percent from 1-100.



Wiring

Diagram	Wire	Connection	Pinout (Male)	Pinout (Female)
	1 - Brown	12 V DC to 30 V DC	<p>1 = Brown 2 = White 3 = Blue 4 = Black</p>	<p>1 = Brown 2 = White 3 = Blue 4 = Black</p>
	2 - White	Not used		
	3 - Blue	DC common		
	4 - Black	Pulse width modulation (PWM) input. For maximum intensity, leave the black wire floating or connected to common. Connecting to 12 V DC to 30 V DC causes LEDs to shut off.		

Specifications

Supply Voltage

12 V DC to 30 V DC
Use only with a suitable Class 2 power supply (UL) or SELV power supply (CE)

Supply Current

Model	Max. Current Draw (A) at 12 V DC	Typical Current Draw (A)		
		12 V DC	24 V DC	30 V DC
WL50-3	0.250	0.220	0.100	0.085

Power-Up Response Time

1 ms maximum for touch models

Dimming and Control

Non-touch models: PWM frequency 100-600 Hz
Touch models: On/off, 10% to 100% dimming, and PWM input
See [Device Configuration](#) on p. 1 for detailed function

Pulse Width Modulation (PWM)

Frequency: Up to 600 Hz
Voltage: 12 V DC to 30 V DC
Current: 3 mA maximum
Duty Cycle Range:
Off - 0%
On - 100%

Supply Protection Circuitry

Protected against reverse polarity and transient voltages

Construction

Housing: Polycarbonate
Connector: Nickel-plated quick-disconnect or PVC-jacketed cable

Mounting

Base mount: M30 x 1.5 threaded base, maximum torque 4.5 N-m (40 in-lbf)
Flat: Included 48 mm (1.9 in) circular velcro mounting kit

Connections

Integral 4-pin M12 male quick disconnect, 150 mm (6 in) PVC cable with an M12 quick disconnect, or 2 m (6.5 ft) integral PVC cable, depending on model
Terminal model: 3 color-coded screw terminals for up to 16 AWG wire, screw terminal maximum torque 0.11 N-m (1.0 lbf-in)

Environmental Rating

Rated IEC IP65, IEC IP67, and IP69K per DIN 40050-9
Cabled models meet IP69K per DIN 40050-9 if the cable is protected from high-pressure spray
The illuminated side of the terminal models meet IEC IP65, IEC IP67, and IP69K per DIN 40050-9 when installed in an enclosure
Terminal connection points meet IEC IP00

LED Lifetime

Lumen maintenance - L70
When operating within specifications, output will decrease less than 30% after 50,000 hours.

Operating Temperature

-40 °C to +50 °C (-40 °F to +122 °F)

Storage Temperature

-40 °C to +70 °C (-40 °F to +158 °F)

Vibration and Mechanical Shock

Vibration: 10 Hz to 55 Hz, 1.0 mm peak-to-peak amplitude per IEC 60068-2-6
Shock: 15G 11 ms duration, half sine wave per IEC 60068-2-27
Impact: IK06 (IEC EN 60068-2-75)

Third Wire Functionality

Touch models: PWM input overrides touch control
Standard models: PWM input full on-off, with 10%-100% dimming

Light Characteristics

Daylight White Efficacy: up to 125 lumens/watt typical at 24 V DC at 25 °C (77 °F)
CRI: 82, typical

Model	Color	Color Temperature (CCT)	Lumens (Typical at 25 °C)	Watts at 24 V DC	Luminous Efficacy (lm/w)
WL50-3	Daylight White	5000 K (±300 K)	300	2.4	125

Certifications and Approvals



Dimensions

All measurements are listed in millimeters [inches], unless noted otherwise.

Flat Mount

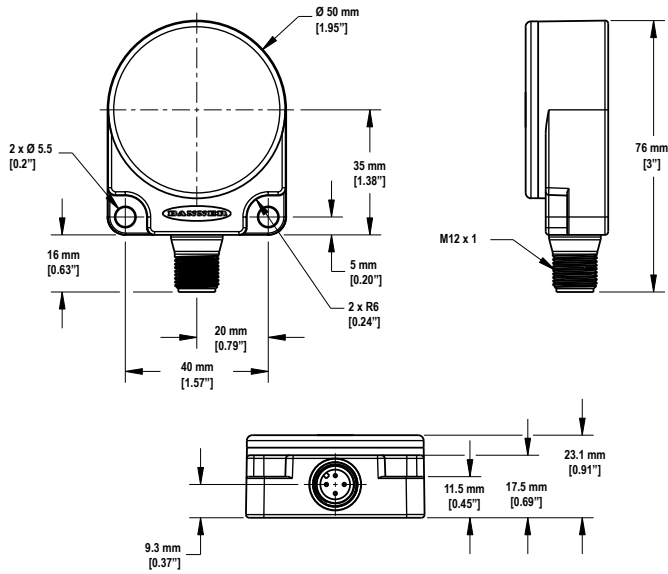

30 mm Base Mount

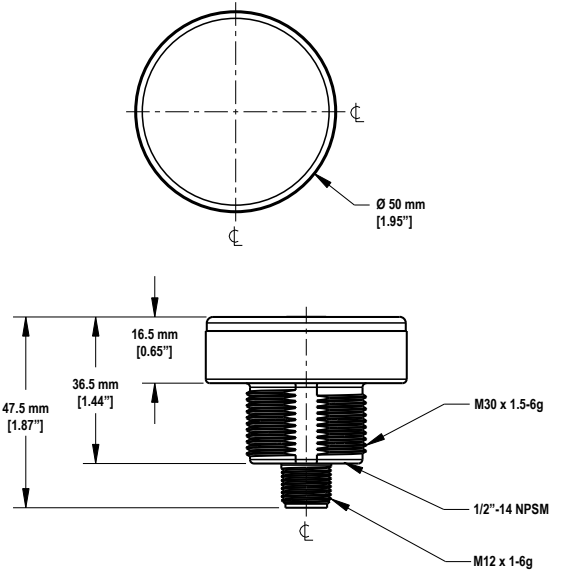

Terminal Base Mount

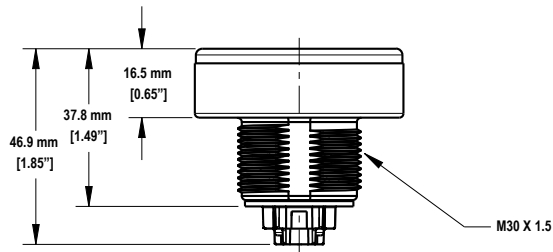

Photometric Data

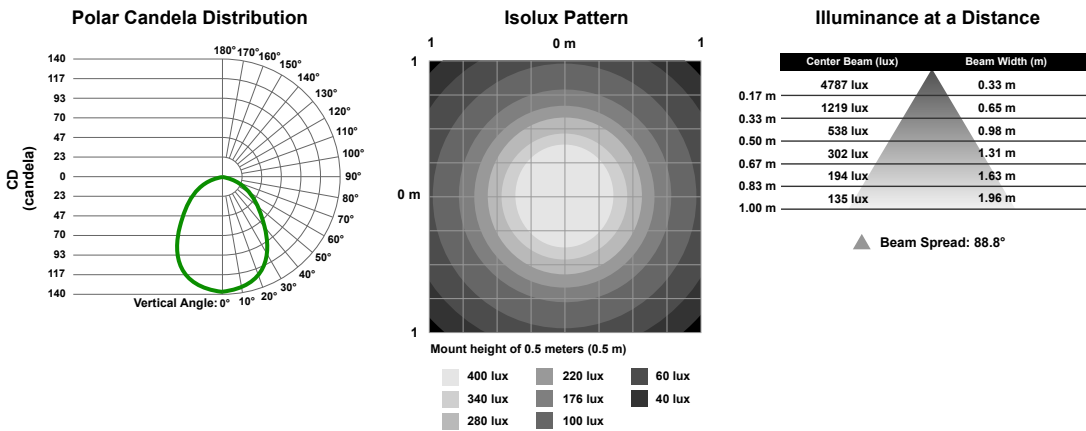

Accessories

Cordsets

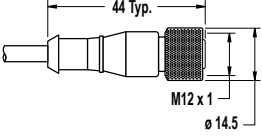
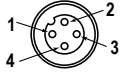
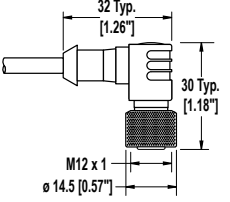
4-Pin Threaded M12 Cordsets—Single Ended				
Model	Length	Style	Dimensions	Pinout (Female)
MQDC-406	2 m (6.56 ft)	Straight		 <p>1 = Brown 2 = White 3 = Blue 4 = Black</p>
MQDC-415	5 m (16.4 ft)			
MQDC-430	9 m (29.5 ft)			
MQDC-450	15 m (49.2 ft)	Right-Angle		
MQDC-406RA	2 m (6.56 ft)			
MQDC-415RA	5 m (16.4 ft)			
MQDC-430RA	9 m (29.5 ft)			
MQDC-450RA	15 m (49.2 ft)			

Dimmers

LC15T-127AP1RBGQP

- In-line capacitive touch switch with M12 connectors
- On/Off or PWM control with illuminated indication
- Rated for up to 30 V DC and 4 A maximum output current
- Rugged and waterproof IEC IP67 housing

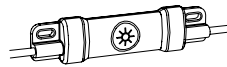

LC65P1T

- Potentiometer with terminal and M12 connector options
- PWM control
- Rated for up to 30 V DC and 4 A maximum output current
- Unsealed IEC IP20 housing

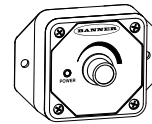

Brackets

SMB30A

- Right-angle bracket with curved slot for versatile orientation
- Clearance for M6 (¼ in) hardware
- Mounting hole for 30 mm sensor
- 12-ga. stainless steel

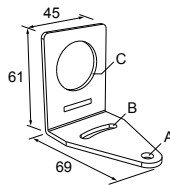

Hole center spacing: A to B=40
Hole size: A=ø 6.3, B=27.1 x 6.3, C=ø 30.5

SMB30SC

- Swivel bracket with 30 mm mounting hole for sensor
- Black reinforced thermoplastic polyester
- Stainless steel mounting and swivel locking hardware included

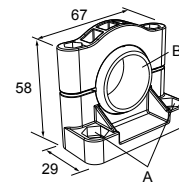

Hole center spacing: A=ø 50.8
Hole size: A=ø 7.0, B=ø 30.0

SMB30MM

- 12-ga. stainless steel bracket with curved mounting slots for versatile orientation
- Clearance for M6 (¼ in) hardware
- Mounting hole for 30 mm sensor

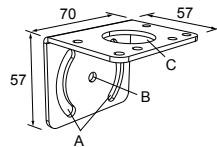

Hole center spacing: A = 51, A to B = 25.4
Hole size: A = 42.6 x 7, B = ø 6.4, C = ø 30.1

Flex Arm Light

- Fully assembled plug and play
- 457 mm (18 in) long
- See Flex Arm Light literature, p/n 222095

