

In-Line Motion Detector

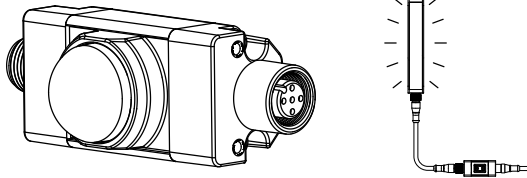

Datasheet



- In-line motion detector switch with M12 connectors
- Rugged metal housing
- Perfect for dc-powered task lights
- Rated for up to 30 V dc



Important: Lea el siguiente instructivo antes de operar el luminario. Por favor descargue desde www.bannerengineering.com toda la documentación técnica de los In-Line Motion Detector, disponibles en múltiples idiomas, para detalles del uso adecuado, aplicaciones, advertencias, y las instrucciones de instalación de estos dispositivos.



Important: Lisez les instructions suivantes avant d'utiliser le luminaire. Veuillez télécharger la documentation technique complète des In-Line Motion Detector sur notre site www.bannerengineering.com pour les détails sur leur utilisation correcte, les applications, les notes de sécurité et les instructions de montage.

Models

Model	Description	Used With
WLS28-2MQ	In-line motion detector switch	2-wire dc LED lights

Specifications

Supply Voltage

12 V dc to 30 V dc max
See electrical characteristics on product label

Current Rating

4 Amps maximum

Motion Detection

Light turns off after approximately 60 seconds without detecting motion
Range: 12 meters; $\pm 45^\circ$ field of view
Standby current: 170 μ A

Construction

Clear anodized aluminum housing; painted zinc end caps; thermoplastic detector; zinc plated steel brackets

Connections

Integral 4-pin M12 quick disconnect male and female fitting

Mounting

(2) swivel brackets SMBWLS28RA included and (4) screws

Environmental Rating

IEC IP50

Operating Temperature

-20°C to $+60^\circ\text{C}$ (-4°F to $+140^\circ\text{F}$)

Storage Temperature

-40°C to $+70^\circ\text{C}$ (-40°F to $+158^\circ\text{F}$)

Certifications



Dimensions

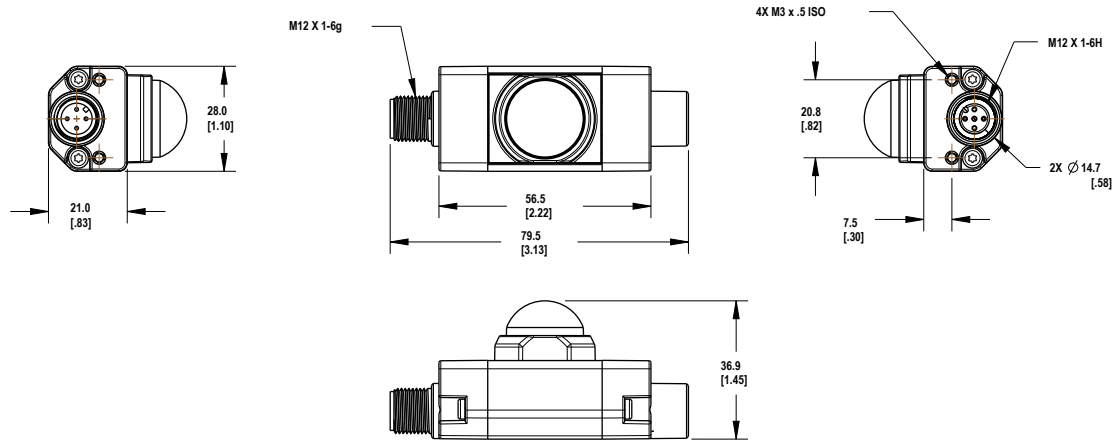

Wiring Diagrams

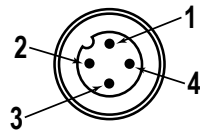

Figure 1. 4-pin M12 Male

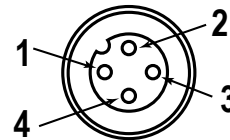

Figure 2. 4-pin M12 Female

Pin	Wire Color	Input (Male)	Output (Female)
1	Brown	V+ dc (30 V max)	V+ dc
3	Blue	dc common	dc common
4	Black	Connect to 12 to 30 V dc to bypass the motion detector switch	Not used
2	White	Not used	Not used

Accessories

Cordsets

4-Pin Threaded M12/Euro-Style Cordsets—Single Ended				
Model	Length	Style	Dimensions	Pinout (Female)
MQDC-406	1.83 m (6 ft)	Straight		
MQDC-415	4.57 m (15 ft)			
MQDC-430	9.14 m (30 ft)			
MQDC-450	15.2 m (50 ft)			

1 = Brown
2 = White
3 = Blue
4 = Black

4-Pin Threaded M12/Euro-Style Cordsets—Single Ended				
Model	Length	Style	Dimensions	Pinout (Female)
MQDC-406RA	1.83 m (6 ft)	Right-Angle		
MQDC-415RA	4.57 m (15 ft)			
MQDC-430RA	9.14 m (30 ft)			
MQDC-450RA	15.2 m (50 ft)			

4-Pin Threaded M12/Euro-Style Cordsets—Double Ended				
Model	Length	Style	Dimensions	Pinout
MQDEC-401SS	0.31 m (1 ft)	Male Straight/ Female Straight		Female
MQDEC-403SS	0.91 m (3 ft)			
MQDEC-406SS	1.83 m (6 ft)			Male
MQDEC-412SS	3.66 m (12 ft)			
MQDEC-420SS	6.10 m (20 ft)			
MQDEC-430SS	9.14 m (30 ft)			
MQDEC-450SS	15.2 m (50 ft)			1 = Brown 2 = White 3 = Blue 4 = Black

Brackets

SMBWLS28RA

The bracket kit is available as a replacement for the one that comes with the light or switch. The kit contains two end brackets and four screws.

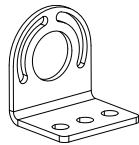

SMBWLS28SM

This kit allows the light or switch to be mounted at a right angle to the mounting surface. The kit contains two end brackets and four screws.

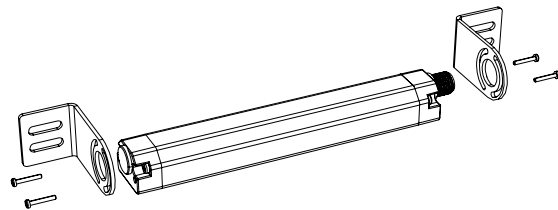

SMBWLS28SP

- Stainless steel snap bracket kit
- Includes two brackets

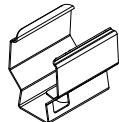

SMH1316

This kit allows the light or switch to be mounted to a 13/16-inch Unistrut channel. Light is shown. The kit includes:

- #10-32 spring nuts (qty 2)
- #10-32 socket head cap screws (qty 2)
- #10 lock washers (qty 2)

