

Expanding the DIN Concept

- Mates with DIN connectors.
- Ideal for automated soldering because the Connectors sit on top of the board.
- Mounting dimensions of the DIN Style-1 Connectors are the same as the DIN connector.
- DIN Style-2 Connectors have widened dimensions for ease of mounting.
- Conform to UL standards (file no. E103202) and CSA standards (file no. LR 62678). (Except XC5K models)

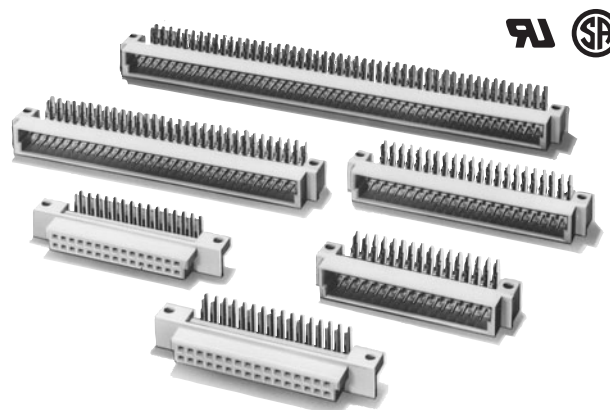

RoHS Compliant

■ Ratings and Characteristics

| | |
|-------------------------------|--|
| Rated current | 2 A |
| Rated voltage | 300 VAC |
| Contact resistance | 20 mΩ max. (at 20 mV, 100 mA max.)* |
| Insulation resistance | 10 ⁶ MΩ min. (at 100 VDC) |
| Dielectric strength | 1,000 VAC for 1 min (leakage current: 1 mA max.) |
| Total insertion force | 0.59 N max. per contact |
| Removal force | 0.15 N min. (with test gauge, t = 0.56 mm) |
| Insertion durability | 50 times |
| Ambient operating temperature | Operating: -55 to 125°C (with no icing) |

*The XC5K is 30mΩ max. (at 20 mV DC max., 100 mA max.)

■ Materials and Finish

| Type | Plugs | Sockets |
|----------|---|---|
| Housings | Fiber-glass reinforced PBT resin (UL94V-0)/gray | |
| Contacts | Mating end | Phosphor bronze/nickel base, 0.15-μm gold plating |
| | Terminal | Phosphor bronze/nickel base, 2.0-μm tin plating |

XC5D Triple-row Sockets, DIN-style Compatible

■ Dimensions

(unit: mm)

XC5D-□□31-0
(With straight DIP terminals)

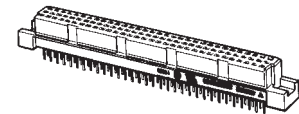
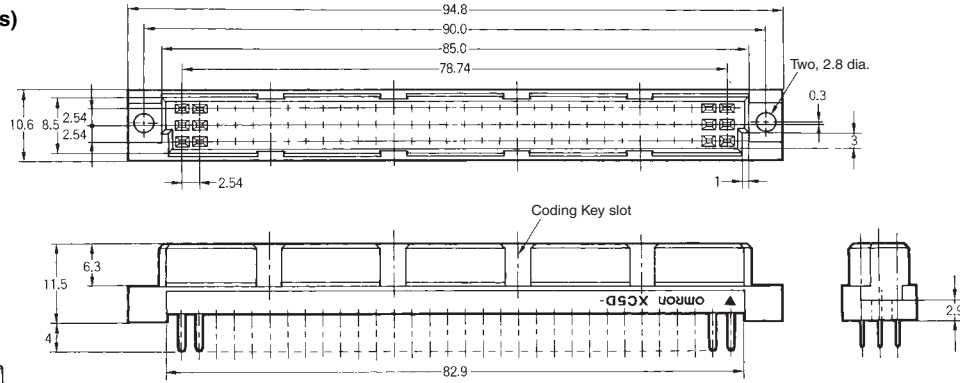

XC5D
DIP terminal cross-section view

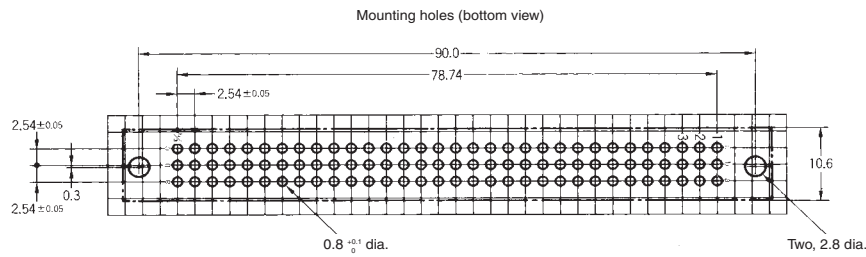
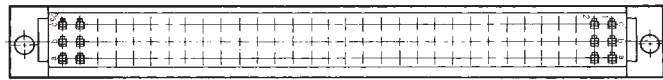
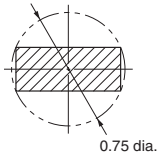

Note: The 64-contact plug does not have the center row (b in the above diagrams).
Contact numbers are not marked on the product.

■ Ordering Information

| No. of contacts | Terminal type | Model |
|-----------------|------------------------|-------------|
| 64* | Straight DIP terminals | XC5D-6431-0 |
| 96 | | XC5D-9631-0 |

*Has no center row (row b).